

Velato[®]

Recessed Slot Adjustable Multiples



Features

A completely unique addition to the Amerlux[®] line, Velato is our response to your requests for a super-flexible, concealed ceiling light with a quasi-custom vibe. Light shoots through the center of this new, concealed multiple, and lands right on target. The Velato faceplate is the key to its unique properties. The versatile Velato is offered in 1, 2 and 3 light multiples. Trimless version also available.

Product Overview

Type: Recessed Slot Multiple, Accent & Display
Wattage: 11, 16, 18
Lumen Output: 1,197 max; 68 Lm/W (Spot optic, 1 light configuration)
CBCP: 8,731 max (Spot optic, 1 light configuration)
Color Temp: 2200K, 2700K, 3000K, 3500K, 4000K, CRISP
CRI: 83 typ. (2700K, 3000K, 3500K, 4000K)
90+ typ. (2200K, 2700K, 3000K, 3500K, 4000K)
CrispWhite (16W max) & 3K Class A
Dimming: TRIAC & ELV (120/277VAC) - 5% Dim
Lutron LDE1 Hi-lume[®] 1% Soft-On/Fade-to-Black, 120/277VAC
0-10V (120/277VAC) - 1% Dim
DALI (120/277VAC) - 1% Dim

PROJECT:

TYPE:

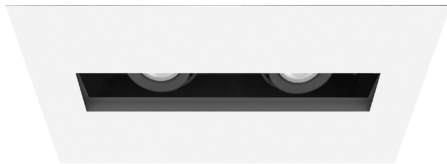

2 Light

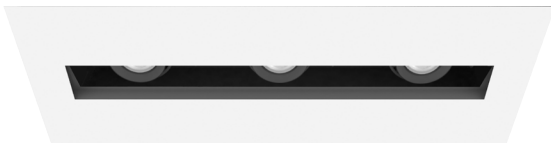

3 Light

Fixture Summary (see following pages for more information)

Fixture Type

# of Heads	New Construction	Remodeler	Trim	Trimless
1	Yes	No	Yes	Yes
2	Yes	No	Yes	Yes
3	Yes	No	Yes	Yes

Performance Chart

Watts	Delivered Lumens	LPW	CBCP	Color Temp
11	732	66	5,336	3000K-83
16	1,064	66	7,761	3000K-83
18	1,197	68	8,731	3000K-83

Data is based on 3000K-80, 120V IES files available on website
Data is based on 1 light configuration with Spot optic



PROJECT:

TYPE:

Frame Ordering Information

1	2	3	4	5
1 <u>Model</u> VEL-NC-FRAME (new construction) VEL-CP-FRAME (Chicago Plenum frame)	2 <u>Style</u> T - trimmed TL - trimless	3 <u># of Heads</u> 1 2 3	4 <u>Voltage</u> 120 277	5 <u>Driver</u> (for non-dimming select LE/TE option) LE/TE - TRIAC/ELV dimming, 5% dim (standard) HILUME-H-ECO - Lutron LDE1 Hi-lume® 1% Soft-On/Fade-to-Black O-10V - 0-10V dimming; 1% dim DALI - EldoLED; 1% dim

Trim Ordering Information

1	2	3	4	5	6	7	8	9	10	11																								
1 <u>Model</u> VEL-HHP-NC-TRIM (new construction) VEL-HHP-CP-TRIM (Chicago Plenum trim)	2 <u>Style</u> T - trimmed TL - trimless	3 <u># of Heads</u> 1 2 3	4 <u>Concealed Type</u> SA - slot adjustable	5 <u>Wattage</u> 11 16 18	6 <u>Voltage</u> 120-277	7 <u>Beam Spreads</u> <table border="1"> <tr> <td>1LT</td> <td>2LT</td> <td>3LT</td> </tr> <tr> <td>SP</td> <td>SP</td> <td>SP</td> </tr> <tr> <td>NF</td> <td>NF</td> <td>NF</td> </tr> <tr> <td>MFL</td> <td>MFL</td> <td>MFL</td> </tr> <tr> <td>FL</td> <td>FL</td> <td>FL</td> </tr> <tr> <td>WF</td> <td>WF</td> <td>WF</td> </tr> <tr> <td>VWF</td> <td>VWF</td> <td>VWF</td> </tr> <tr> <td>LS</td> <td>LS</td> <td>LS</td> </tr> </table> SP- spot 15°, NF- narrow flood 22°, MFL- medium flood 25°, FL- flood 28°, WF- wide flood 45°, VWF- very wide flood 60°, LS- linear spread lens 60° x 10°	1LT	2LT	3LT	SP	SP	SP	NF	NF	NF	MFL	MFL	MFL	FL	FL	FL	WF	WF	WF	VWF	VWF	VWF	LS	LS	LS	8 <u>Color Temp</u> 83 CRI: 90+ CRI: 27 - 2700K-83 229* - 2200K-90+ CRISP+ - CrispWhite 30 - 3000K-83 279 - 2700K-90+ 3CLA+ - 3K Class A 35 - 3500K-83 309 - 3000K-90+ 40 - 4000K-83 359 - 3500K-90+ 409 - 4000K-90+ * <i>Not available for 18W</i>	9 <u>Faceplate Finish</u> MW- matte white	10 <u>Driver</u> (for non-dimming select LE/TE option) LE/TE - TRIAC/ELV dimming HILUME-H-ECO - Lutron LDE1 Hi-lume® 1% Soft-On/Fade-to-Black O-10V - 0-10V dimming; 1% dim DALI - EldoLED; 1% dim	11 <u>Options/Accessories</u> AH - accessory holder, accepts (2) 1/8" forms of media and optical film HEX - hexcell louver (requires AH)
1LT	2LT	3LT																																
SP	SP	SP																																
NF	NF	NF																																
MFL	MFL	MFL																																
FL	FL	FL																																
WF	WF	WF																																
VWF	VWF	VWF																																
LS	LS	LS																																

PROJECT:

TYPE:

Specifications

Application

Retail, commercial and hospitality accent and display lighting

Construction

Stamped steel mounting frame with integral mounting bars
Thermally protected (adds 2W to total fixture wattage)
Steel driver housing
Extruded aluminum upper housing
Steel plaster frame (trimless only)
Complete die-cast optical head construction
No exposed wiring

Optical

Tilt: 0-30
Rotation: 360°+
Beam Spreads: Spot, 15°; Narrow Flood, 22°;
Medium Flood, 25°; Flood, 28°; Wide Flood, 45°;
Very Wide Flood, 60°; Linear Spread, 60° x 10°

LED

Color Temp Options:
2200K, 2700K, 3000K, 3500K, 4000K, CRISP
CRI: 83 typ. (2700K, 3000K, 3500K, 4000K)
90+ typ. (2200K, 2700K, 3000K, 3500K, 4000K)
CrispWhite* LED available, 16W max
Class A 3000K (high CRI, high gamut)

R9 Values: 11 (83 CRI), 55 (92 CRI)

Binning: 3 MacAdam (SDCM)

Life: 50,000+ hrs, > 70% of initial lumens at 50,000 hrs

**CrispWhite: CrispWhite Technology delivers the warmth of colors expected from a high 90 CRI solution but also creates the natural crisp white color that is pleasing to the eye. It creates the most impactful lighting ever available, by revealing the richest whites and vibrant colors that pop.*

***Class A LED: Class A LED's have a CRI > 80 and a GAI > 80. CRI defines color "Naturalness" and GAI defines color "Saturation." Both being high delivers rich colors and pure whites.*

Electrical

Wattage: 11, 16, 18

Electronic constant current LED driver, 120/277VAC input

This product complies with IEEE C62.41 for surge endurance up to 2.5KV. Amerlux® recommends using additional surge protection with this unit (supplied by others), surge and over voltage damage is not covered under warranty.

Drivers

LE/TE - Leading Edge, TRIAC, forward phase/Trailing Edge, ELV, reverse phase

0-10V, Lutron and DALI systems also available

See pages 7-8 for more dimming information

Finish

Powder coat paint

Mounting

For use in T-Grid or GB ceilings; max ceiling thickness 1"

Adjustable hanger bars included (14 1/2" - 25" std.)

(32"-48" Adjustable hanger bars available)

Consult Factory for thicker ceilings

Certifications

CSA listed to UL standards. Suitable for damp locations

Indoor use only

Warranty

5 year limited warranty

Accessories (diagrams show installation order)

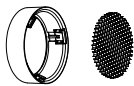

Accessory holder, hexcell louver

Plaster Frame Installation Detail (for trimless fixture only)

1. Removable bottom face plate
2. Plaster frame
3. Plaster skim coat (by others)
4. Ceiling
5. Sheetrock screws (by others)

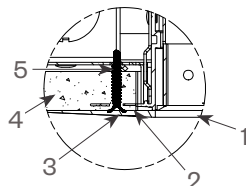

PROJECT:

TYPE:

Electrical Data

1 Light

	1 x 11W		1 x 16W		1 x 18W	
	System Watts	Amps	System Watts	Amps	System Watts	Amps
120V	11	0.09	16	0.13	18	0.15
277V	11	0.04	16	0.06	18	0.07

Electronic constant current LED driver

2 Light

	2 x 11W		2 x 16W		2 x 18W	
	System Watts	Amps	System Watts	Amps	System Watts	Amps
120V	22	0.18	32	0.27	36	0.30
277V	22	0.08	32	0.12	36	0.13

Electronic constant current LED driver

3 Light

	3 x 11W		3 x 16W		3 x 18W	
	System Watts	Amps	System Watts	Amps	System Watts	Amps
120V	33	0.28	48	0.40	54	0.45
277V	33	0.12	48	0.17	54	0.19

Electronic constant current LED driver

PROJECT:

TYPE:

Velato Slot Adjustable Multiples: Recessed

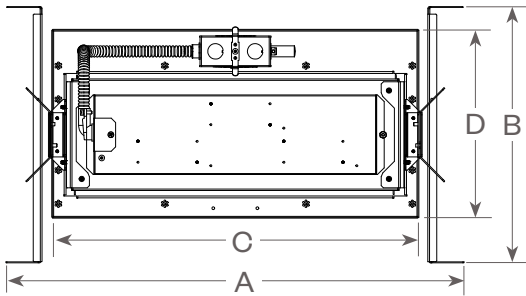

	1 Light	2 Light	3 Light
A	13 3/4"	20 1/4"	26"
B	14 1/2" max 25"	14 1/2" max 25"	14 1/2" max 25"
C	8 9/16"	15 1/16"	20 13/16"
D	10 11/16"	10 11/16"	10 11/16"

Ceiling cut out: 1 Light - 7 1/8" x 7 1/8"
 2 Light - 7 1/8" x 13 5/8"
 3 Light - 7 1/8" x 19 3/4"

End View

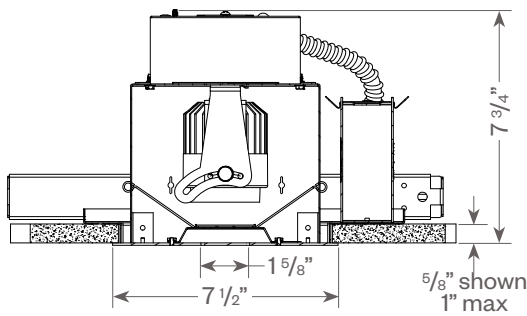

Bottom View

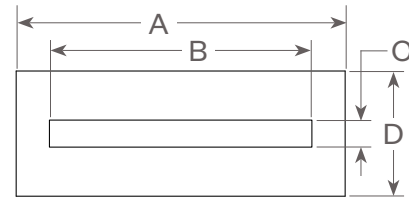

	1 Light	2 Light	3 Light
A	7 1/2"	14"	19 3/4"
B	3 1/2"	10"	15 3/4"
C	1 5/8"	1 5/8"	1 5/8"
D	7 1/2"	7 1/2"	7 1/2"

Side View

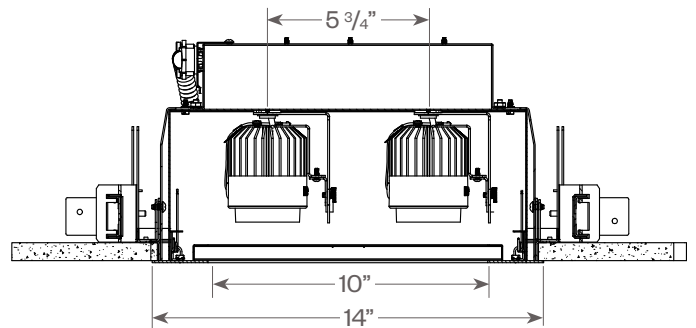
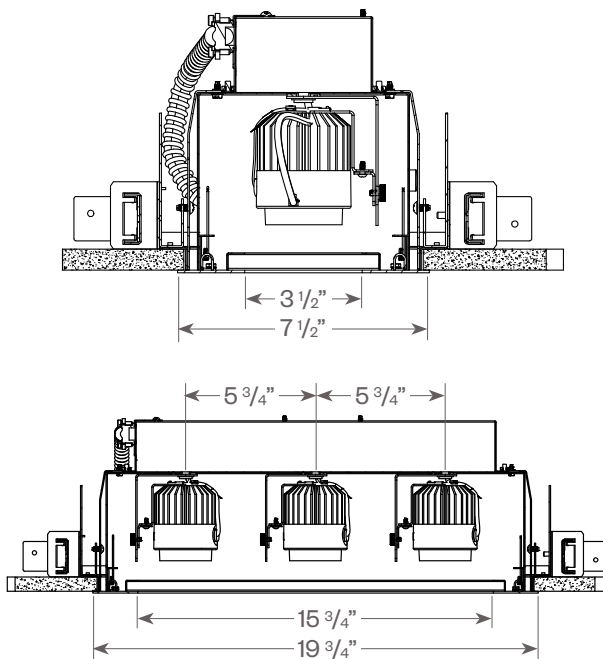

PROJECT:

TYPE:

Velato Slot Adjustable Multiples: Recessed Trimless

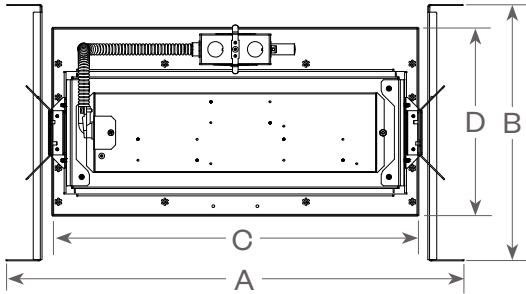

	1 Light	2 Light	3 Light
A	13 3/4"	20 1/4"	26"
B	14 1/2" max 25"	14 1/2" max 25"	14 1/2" max 25"
C	8 9/16"	15 1/16"	20 13/16"
D	10 11/16"	10 11/16"	10 11/16"

Ceiling cut out: 1 Light - 7 1/8" x 7 1/8"
 2 Light - 7 1/8" x 13 5/8"
 3 Light - 7 1/8" x 19 3/4"

End View

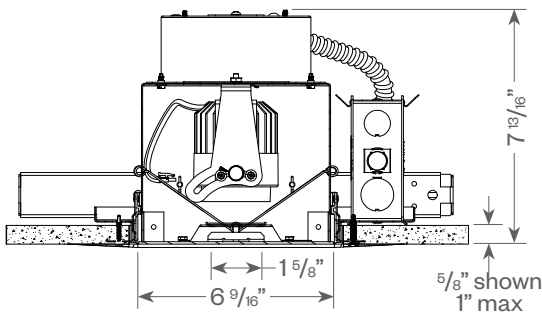

Bottom View

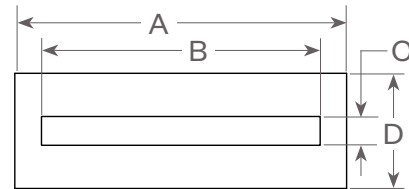

	1 Light	2 Light	3 Light
A	7 1/2"	14"	19 3/4"
B	3 1/2"	10"	15 3/4"
C	1 5/8"	1 5/8"	1 5/8"
D	7 1/2"	7 1/2"	7 1/2"

Side View

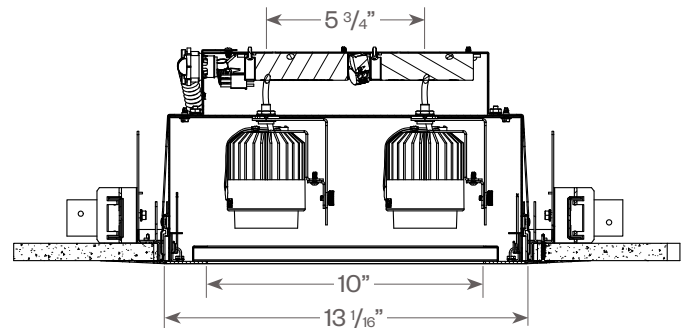
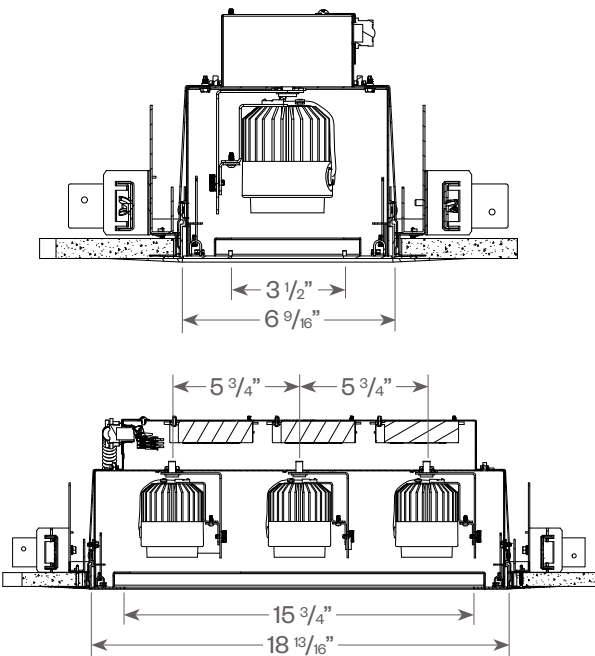

PROJECT:

TYPE:

DIMMING COMPATIBILITY:

Amerlux® Velato fixtures are compatible with all major dimming protocols prevalent in the United States. Please see below for general compatibilities and wiring diagrams. Amerlux recommends testing your unique dimming configuration as the exact full configuration (Dimmer, Fixture Quantity, Voltage, etc) may affect dimming performance.

--- NOTE: INFORMATION BELOW IS FOR WIRED DIMMERS ONLY. FOR WIRELESS DIMMERS, CONSULT FACTORY ---

TRIAC (Forward Phase) DIMMING (Standard)

Utilizes standard TRIAC dimmers that are in wide use in installations across the US. Best for retrofit applications where TRIAC dimmers are installed.

Notes:

- 120VAC or 277VAC*
- Dims down to 5% light output (most cases)
- Consult Dimming manufacturer for installation instructions - DO NOT SHARE NEUTRALS!
- Must meet dimmer Minimum Load Requirements per dimming manufacturer

TRIAC Wiring Diagram

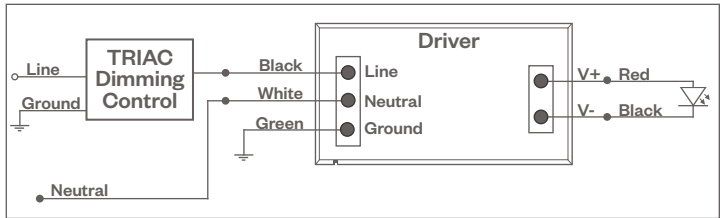

Compatible Dimmers†:

Wall Box (TRIAC 120VAC)	Central System
Lutron "Diva"	Lutron "GP" Panel
Lutron "Nova-T"	Lutron Grafik Eye QS
Lutron "Maestro"	
Lutron "Skylark"	

ELV - Electronic Low Voltage (Reverse Phase) DIMMING (Standard)

Utilizes specialized "ELV" dimmers.

Notes:

- 120VAC or 277VAC*
- Dims down to 5% light output (most cases)
- Consult Dimming manufacturer for installation instructions - DO NOT SHARE NEUTRALS!
- Must meet dimmer Minimum Load Requirements

ELV Wiring Diagram

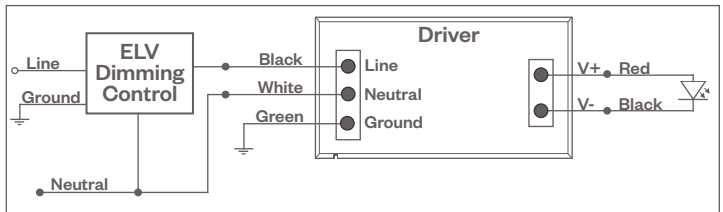

Compatible Dimmers†:

Wall Box (ELV 120VAC)	Wall Box (ELV 277VAC)	Central System
Lutron "Diva"	Leviton Revoir II AWSMT-E	Lutron "GP" Panel with PHPM-PA 120/277VAC
Lutron "Nova-T"		Lutron Grafik Eye QS with PHPM-PA 120/277VAC
Lutron "Maestro"		
Lutron "Skylark"		
Leviton "Surslide"		
Leviton "Vizio"		

Notes:

- * Driver is 277VAC dimmable with appropriate dimmer (by others). All provided wiring diagrams show 120VAC wiring colors and method. Please refer to 277VAC dimmer manufacturer installation instructions for 277VAC wiring diagrams.
- † The absence of a dimmer from the lists above does not imply incompatibility. Please consult factory for compatibility inquiries.

PROJECT:

TYPE:

DIMMING COMPATIBILITY:

Amerlux® Hornet fixtures are compatible with all major dimming protocols prevalent in the United States. Please see below for general compatibilities and wiring diagrams. Amerlux recommends testing your unique dimming configuration as the exact full configuration (Dimmer, Fixture Quantity, Voltage, etc) may affect dimming performance.

--- NOTE: INFORMATION BELOW IS FOR WIRED DIMMERS ONLY. FOR WIRELESS DIMMERS, CONSULT FACTORY ---

0-10V DIMMING

Integrates into a variety of building management and daylighting controls

Notes:

- 120VAC or 277VAC*
- Dims down to 1% light output
- Requires interface to turn off power to driver
- Consult Dimming manufacturer for installation instructions - DO NOT SHARE NEUTRALS!

0-10V Wiring Diagram

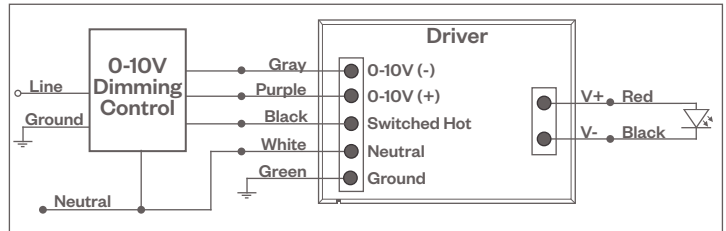

Compatible Dimmers*:

Wall Box

Lutron "Diva" - DVSTV | Leviton Renoir II 0-10V

Central System

Lutron Grafik Eye with GRX-TV1 Interface

LUTRON LDE1 DIMMING

Integrates into Lutron EcoSystem building management

Notes:

- 120VAC or 277VAC*
- Dims down to 1% Soft-On/Fade-to-Black
- EcoSystem Control
- Consult Dimming manufacturer for installation instructions - DO NOT SHARE NEUTRALS!

Lutron LDE1 (HILUME-H-ECO)

EcoSystem Digital Control Wiring Diagram

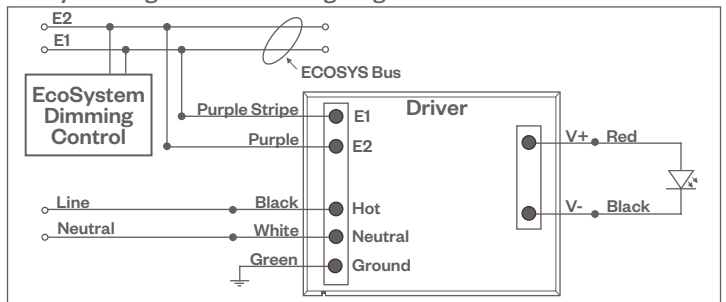

Compatible Dimmers*:

Lutron ECO System

Pow Pak Dimming Modules
Energj Savr Node
Grafik Eye QS/Homeworks
QS Control Unit
Quantum Hub
Homeworks QS/My Room

Central System

Lutron EcoSystem compatible controls

DALI DIMMING

Digital control protocol allows individual fixture control

Notes:

- 120VAC - 277VAC*
- Dims down to 1% light output in most cases

DALI Wiring Diagram

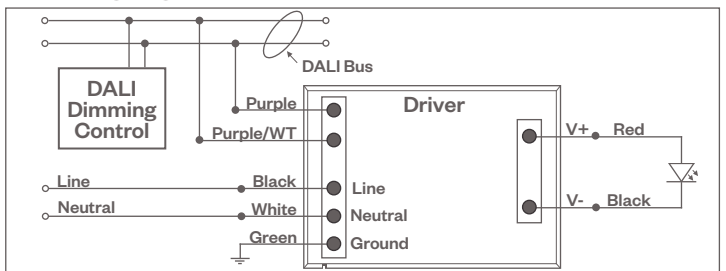

Compatible Dimmers*:

Wall Box (3-Wire Fluorescent)

Leviton CD250 Controller

Central System

Dynalite
Fifth Light

Notes:

- * Driver is 277VAC dimmable with appropriate dimmer (by others). All provided wiring diagrams show 120VAC wiring colors and method. Please refer to 277VAC dimmer manufacturer installation instructions for 277VAC wiring diagrams.
- † The absence of a dimmer from the lists above does not imply incompatibility. Please consult factory for compatibility inquiries.