

Hornet® HP

Retrofit Multiples



PROJECT:

TYPE:

Features

Amerlux LED multiples retrofit provides a quick, easy, elegant way to completely renew your store's look, and also to create better cost-efficiencies and savings. Our retrofits install into existing Amerlux housings of halogen, ceramic metal halide, and early LED, and do not require professional installation. With Amerlux LED multiples retrofits, you enjoy 50,000+ hrs of clear, crisp, dimmable instant-on light. Almost immediately your store is beautiful again.



Product Overview

Type: Retrofit Multiple, Accent & Display
 Wattage: 11W, 16W, 18W
 Color Temp: 2200K, 2700K, 3000K, 3500K, 4000K
 CRI: 83 typ. (2700K, 3000K, 3500K, 4000K)
 90+ typ. (2200K, 2700K, 3000K, 3500K, 4000K)
 CrispWhite & 3K Class A LEDs available (16W max)
 Dimming: TRIAC & ELV, 5% Dim, 120/277VAC
 Lutron LDE1 Hi-lume® 1% Dim Soft-On/Fade-to-Black, 120/277VAC
 0-10V, 1% Dim, 120/277VAC
 DALI, 1% Dim, 120/277VAC

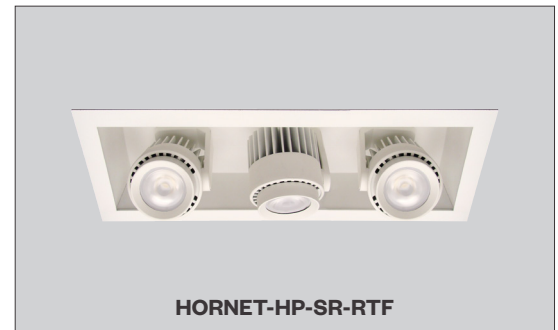

Certifications



Fixture Summary

Fixture Type

# of Heads	New Construction	Remodeler	Trim	Trimless
1	Yes	No	Yes	Yes
2	Yes	No	Yes	Yes
3	Yes	No	Yes	Yes
4	Yes	No	Yes	Yes

See separate spec sheet for Semi-Recessed or Remodeler versions.

Performance Data

Watts	Delivered Lumens	LPW	CBCP	Color Temp-CRI
11	1030	93.7	8,243	3000K-83
16	1451	90.7	11,610	3000K-83
18	1640	91.1	13,119	3000K-83

Data is based on 3000K-83, 120V IES files available on website.

Data is "per head" and based on Spot optic.

See page 13 for other beam spreads.

Hornet® HP

Retrofit Multiples



PROJECT:

TYPE:

Ordering Information

120-277									
1	2	3	4	5	6	7	8	9	10
1 Model	2 Style			3 # of Heads	4 Wattage	5 Finish (for housing, head & trim)			
HORNET-HP-R-RTF (<i>recessed</i>)	T trimmed			1	11	WT white texture			
HORNET-HP-SR-RTF (<i>semi-recessed</i>)	TL trimless			2	16	BT black texture			
				3	18	ST silver texture			
				4		Other finishes, consult factory			
6 Voltage	7 Beam Spread				8 Options				
120-277	1LT	2LT	3LT	4LT	83 CRI		90+ CRI		
	SP	SP	SP	SP	27 2700K-83		229+ 2200K-90+		CRISP+ CrispWhite
	NF	NF	NF	NF	30 3000K-83		279 2700K-90+		3CLA+ 3000K Class A
	MFL	MFL	MFL	MFL	35 3500K-83		309 3000K-90+		
	FL	FL	FL	FL	40 4000K-83		359 3500K-90+		
	WF	WF	WF	WF			409 4000K-90+		
	VWF	VWF	VWF	VWF	* Not available for 18W				
	LS	LS	LS	LS					
9 Driver (for non-dimming select LE/TE option)	10 Options								
Note: Driver selected must match your current system					SNAH snoot accessory holder, 1" length, matte black interior, exterior finish matches fixture finish, accepts cross blade plus 2 additional forms of media				
LE/TE TRIAC/ELV dimming, 5% dim					AH accessory holder, finish matches fixture finish, accepts 2 forms of media				
HILUME-H-ECO Lutron LDE1 Hi-lume® 1% dim Soft-On/Fade-to-Black					HEX hexcell louver, 1/8"x1/8" (requires SNAH or AH)				
0-10V 0-10V dimming, 1% dim					SOL solite beam softening lens (requires SNAH or AH)				
DALI EldoLED; 1% dim					CB cross blade, matte black finish (requires SNAH)				

PROJECT:

TYPE:

Specifications

Application

Retail, commercial and hospitality accent and display lighting

Construction

Thermally protected (*adds 2W to total fixture wattage*)
Steel driver housing
Steel upper housing and laser cut trim ring
Steel plaster frame (*trimless only*)
Complete die-cast optical head construction
No exposed wiring

Optical

Tilt: 0-35°x35° (*Trimmed*), 0-20°x40° (*Trimless*)
Rotation: 360°+
Beam Spreads: Spot, 15°; Narrow Flood, 22°; Medium Flood, 25°;
Flood, 28°; Wide Flood, 40°; Very Wide Flood, 60°;
Linear Spread, 60° x 10°

LED

Color Temp Options: 2200K, 2700K, 3000K, 3500K, 4000K,
CRISP, Class A

CRI: 83 typ. (*2700K, 3000K, 3500K, 4000K*)
90+ typ. (*2200K, 2700K, 3000K, 3500K, 4000K*)
CrispWhite* LED (*16W max*)
Class A** 3000K LED (*high CRI, high gamut, 16W max*)

R9 Values: 11 (*83 CRI*), 55 (*90+ CRI*)

Binning: 3-step MacAdam ellipse (*SDCM*)

Life: 50,000+ hrs, > 70% of initial lumens at 50,000 hrs

* *CrispWhite: CrispWhite Technology delivers the warmth of colors expected from a high 90 CRI solution but also creates the natural crisp white color that is pleasing to the eye. It creates the most impactful lighting ever available, by revealing the richest whites and vibrant colors that pop.*

** *Class A LED: Class A LED's have a CRI > 80 and a GAI > 80. CRI defines color "Naturalness" and GAI defines color "Saturation." Both being high delivers rich colors and pure whites.*

Electrical

Wattage: 11W, 16W, 18W

Electronic constant current LED driver, 120/277VAC input

This product complies with IEEE C62.41 for surge endurance up to 2.5KV. Amerlux® recommends using additional surge protection with this unit (supplied by others), surge and over voltage damage is not covered under warranty.

Drivers

LE/TE - Leading Edge (*Triac, Forward Phase*) or Trailing Edge (*ELV, Reverse Phase*) autosensing driver dims down to 5% on most dimming systems.
0-10V, Lutron and DALI systems also available
See pages 14-15 for more dimming information

Finish

Powder coat paint
Consult Factory for custom finishes

Mounting

Installs into existing Amerlux housings of halogen, ceramic metal halide and early LED.

Certifications

CSA listed to UL standards. Suitable for damp locations
Indoor use only

Warranty

5 year limited warranty

PROJECT:	TYPE:
-----------------	--------------

Electrical Data

NOTE: System Watts includes an additional 2W for thermal protector power consumption.

1 Light

	1 x 11W		1 x 16W		1 x 18W	
Voltage	System Watts	Amps	SystemWatts	Amps	System Watts	Amps
120V	11	0.09	16	0.13	18	0.15
277V	11	0.04	16	0.06	18	0.07

Electronic constant current LED driver.

2 Light

	2 x 11W		2 x 16W		2 x 18W	
Voltage	System Watts	Amps	SystemWatts	Amps	System Watts	Amps
120V	22	0.18	32	0.27	36	0.30
277V	22	0.08	32	0.12	36	0.13

Electronic constant current LED driver.

3 Light

	3 x 11W		3 x 16W		3 x 18W	
Voltage	System Watts	Amps	SystemWatts	Amps	System Watts	Amps
120V	33	0.28	48	0.40	54	0.45
277V	33	0.12	48	0.17	54	0.19

Electronic constant current LED driver.

4 Light

	4 x 11W		4 x 16W		4 x 18W	
Voltage	System Watts	Amps	SystemWatts	Amps	System Watts	Amps
120V	44	0.37	64	0.53	72	0.60
277V	44	0.16	64	0.23	72	0.26

Electronic constant current LED driver.

Accessories (diagrams show installation order)

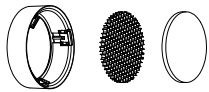

Accessory holder, hexcell louver, solite lens

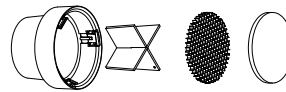

Snoot accessory holder, cross blade, hexcell louver, solite lens

Plaster Frame Installation Detail (for trimless fixture only)

1. Recessed extruded housing
2. Aperture plate
3. Ceiling 5/8"
4. Drywall screw (by others)
5. Plaster frame
6. Plaster skim coat (by others)

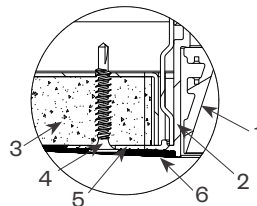

Hornet® HP

Retrofit Multiples



PROJECT:

TYPE:

Product Details - Recessed Trimmed with ELV/TRIAC Driver

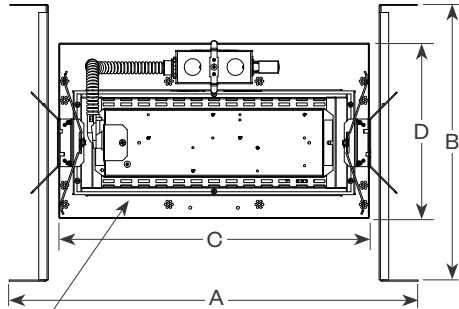

Note: Frame with hanger bars & junction box already installed from previous fixture.

	1 Light	2 Light	3 Light	4 Light
A	12 1/8"	17"	21 1/2"	26"
B	14 1/2" max 25"	14 1/2" max 25"	14 1/2" max 25"	14 1/2" max 25"
C	7 1/16"	11 13/16"	16 5/16"	20 13/16"
D	9 1/8"	9 1/8"	9 1/8"	9 1/8"

Ceiling Cut Out: 1 Light - 5 9/16" x 5 9/16"
 2 Light - 5 9/16" x 10 5/16"
 3 Light - 5 9/16" x 14 13/16"
 4 Light - 5 9/16" x 19 5/16"

End View

Standard Driver (ELV/TRIAC)

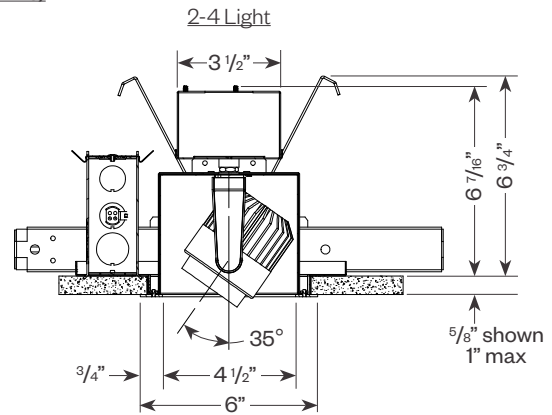
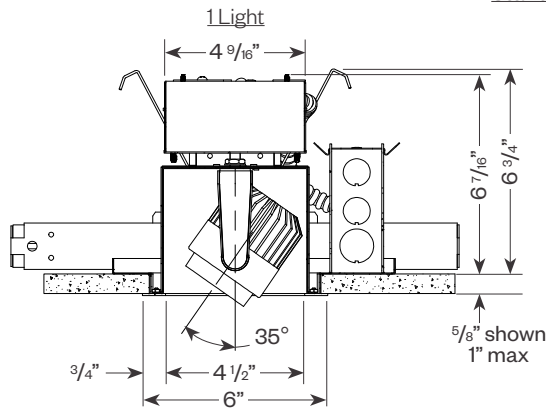

Side View

Standard Driver (ELV/TRIAC)

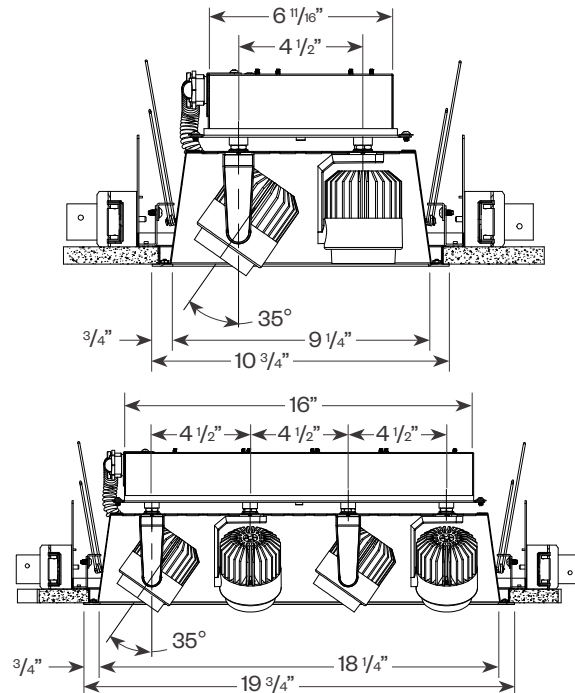
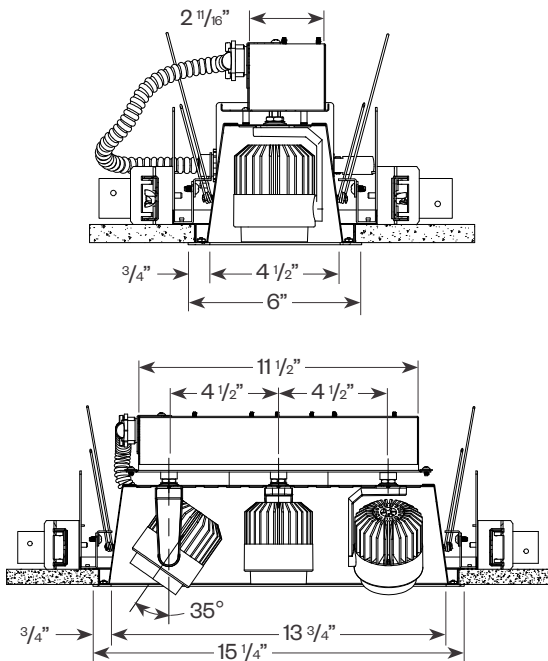

Hornet® HP

Retrofit Multiples



PROJECT:

TYPE:

Product Details - Recessed Trimmed with Hi-lume®/0-10V/DALI Driver

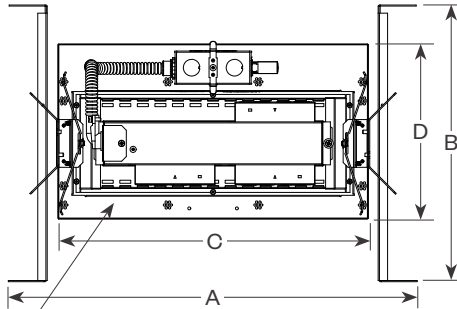

Note: Frame with hanger bars & junction box already installed from previous fixture.

	1 Light	2 Light	3 Light	4 Light
A	12 1/8"	17"	21 1/2"	26"
B	14 1/2" max 25"	14 1/2" max 25"	14 1/2" max 25"	14 1/2" max 25"
C	7 1/16"	11 13/16"	16 5/16"	20 13/16"
D	9 1/8"	9 1/8"	9 1/8"	9 1/8"

Ceiling Cut Out: 1 Light - 5 9/16" x 5 9/16"
 2 Light - 5 9/16" x 10 5/16"
 3 Light - 5 9/16" x 14 13/16"
 4 Light - 5 9/16" x 19 5/16"

End View

Hi-lume®/0-10V/DALI Driver

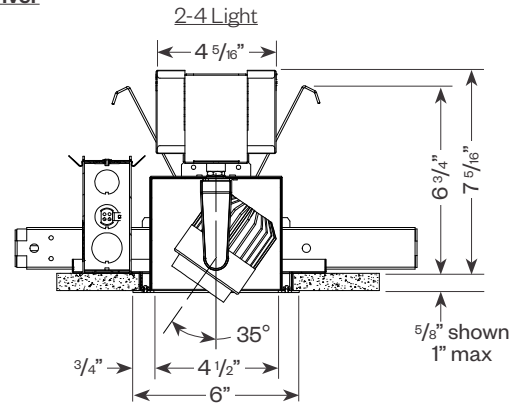
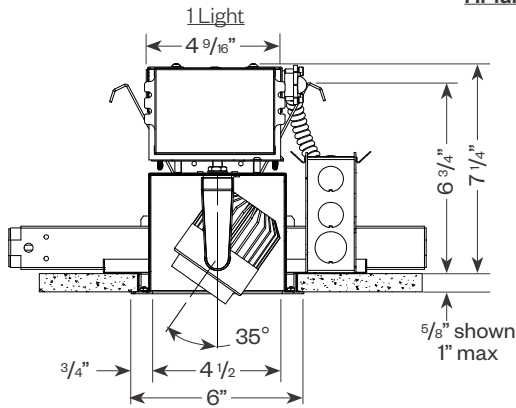

Side View

Hi-lume®/0-10V/DALI Driver

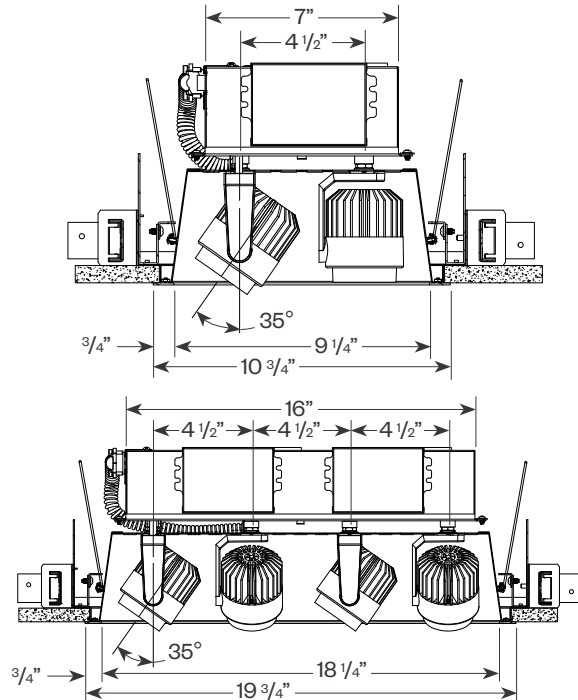
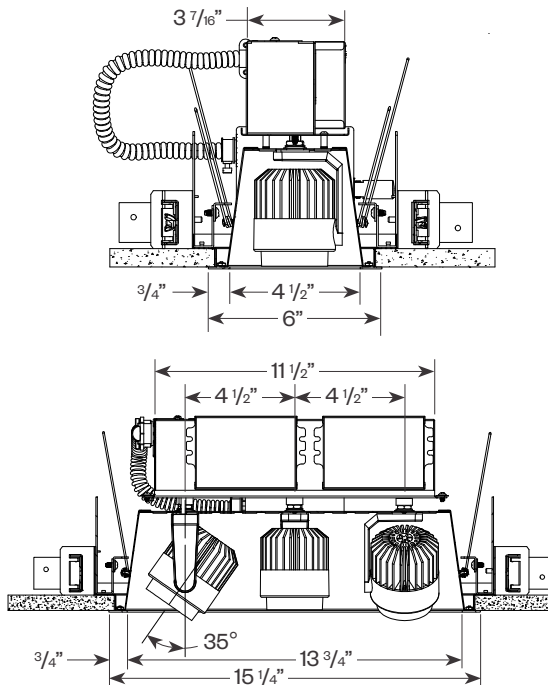

Hornet® HP

Retrofit Multiples



PROJECT:

TYPE:

Product Details - Recessed Trimmed with ELV/TRIAC Driver (see trimless detail on page 4)

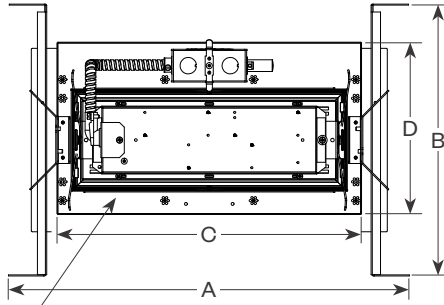

Note: Frame with hanger bars & junction box already installed from previous fixture.

	1 Light	2 Light	3 Light	4 Light
A	12 1/8"	17"	21 1/2"	26"
B	14 1/2" max 25"	14 1/2" max 25"	14 1/2" max 25"	14 1/2" max 25"
C	7 1/16"	11 13/16"	16 5/16"	20 13/16"
D	9 1/8"	9 1/8"	9 1/8"	9 1/8"

Ceiling Cut Out: 1 Light - 5 9/16" x 5 9/16"
 2 Light - 5 9/16" x 10 5/16"
 3 Light - 5 9/16" x 14 13/16"
 4 Light - 5 9/16" x 19 5/16"

End View

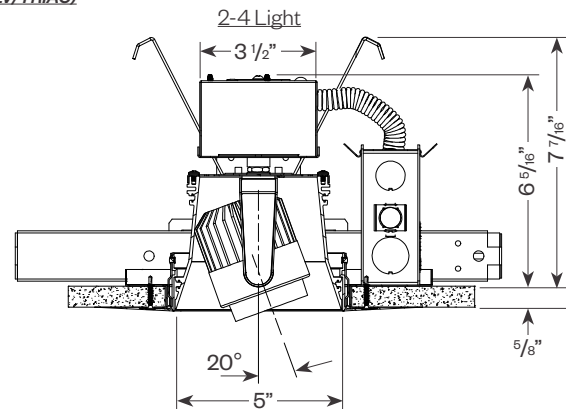
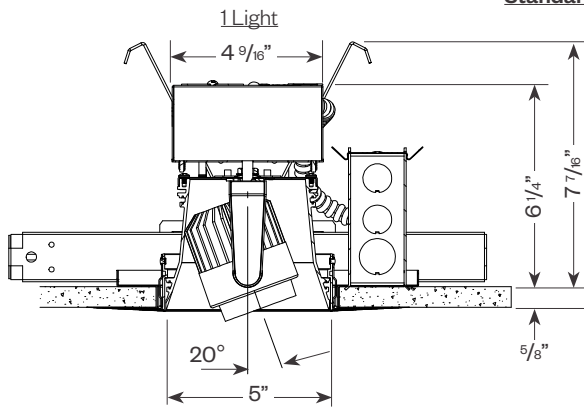

Side View

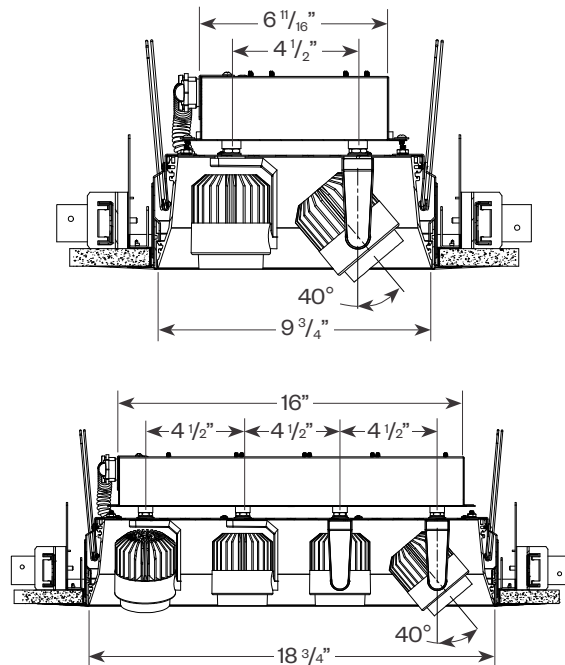
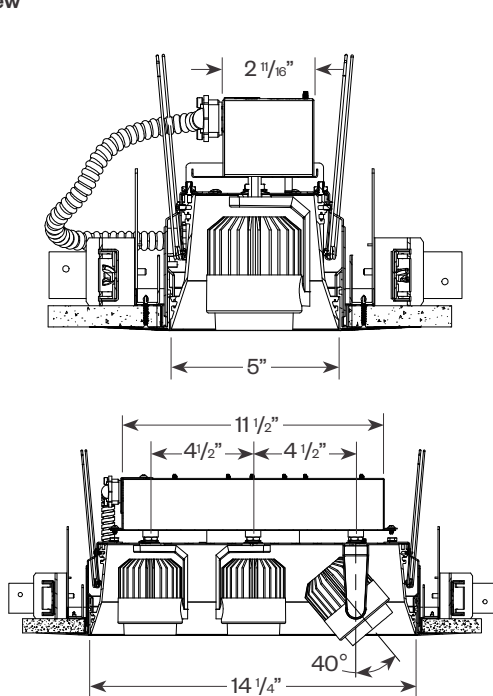

Hornet® HP

Retrofit Multiples



PROJECT:

TYPE:

Product Details - Recessed Trimmed with Hi-lume®/0-10V/DALI Driver (see trimless detail on page 4)

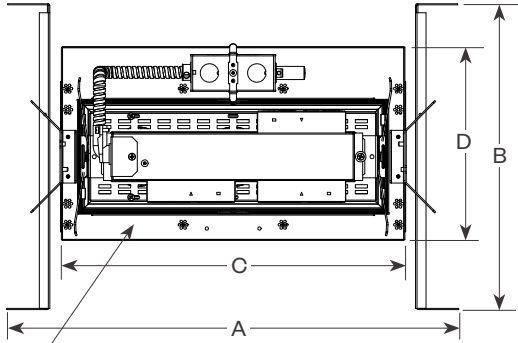

Note: Frame with hanger bars & junction box already installed from previous fixture.

	1 Light	2 Light	3 Light	4 Light
A	12 1/8"	17"	21 1/2"	26"
B	14 1/2"	14 1/2"	14 1/2"	14 1/2"
	max 25"	max 25"	max 25"	max 25"
C	7 1/16"	11 13/16"	16 5/16"	20 13/16"
D	9 1/8"	9 1/8"	9 1/8"	9 1/8"

Ceiling Cut Out: 1 Light - 5 9/16" x 5 9/16"
 2 Light - 5 9/16" x 10 5/16"
 3 Light - 5 9/16" x 14 13/16"
 4 Light - 5 9/16" x 19 5/16"

End View

Hi-lume®/0-10V/DALI Driver

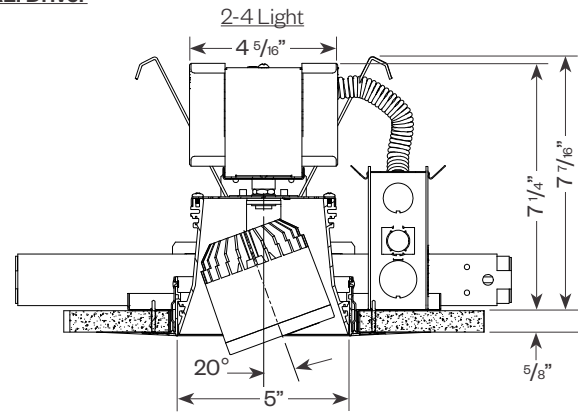
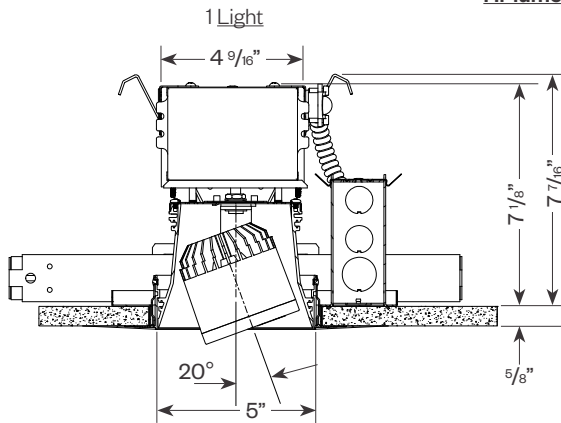

Side View

Hi-lume®/0-10V/DALI Driver

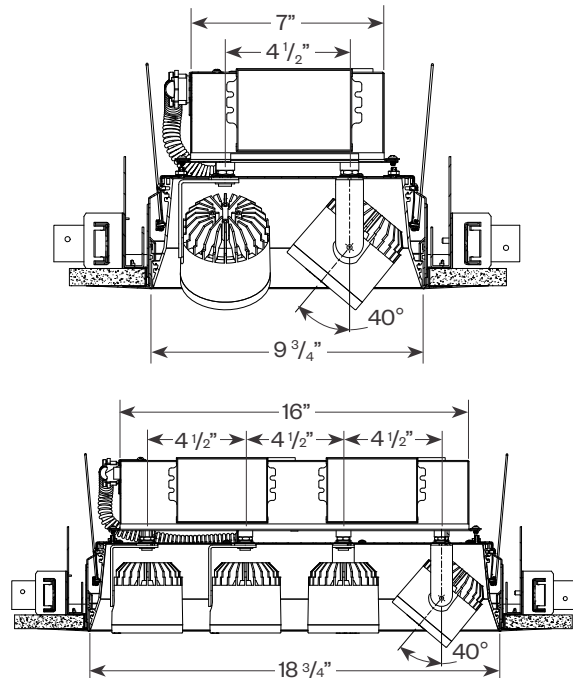
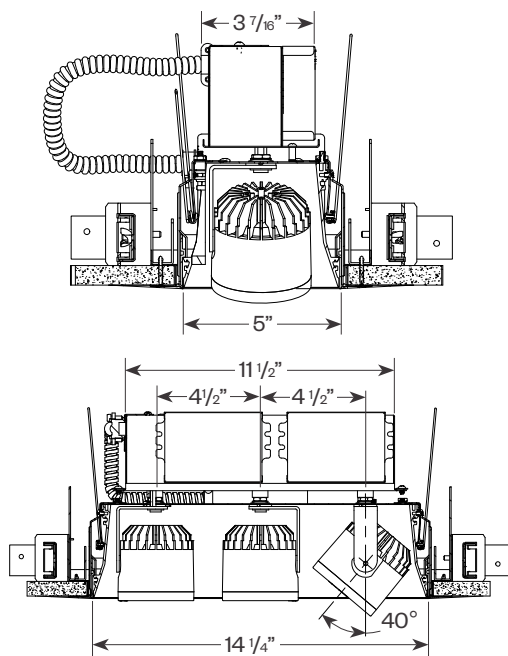

PROJECT:

TYPE:

Product Details - Semi-Recessed Trimmed with ELV/TRIAC Driver

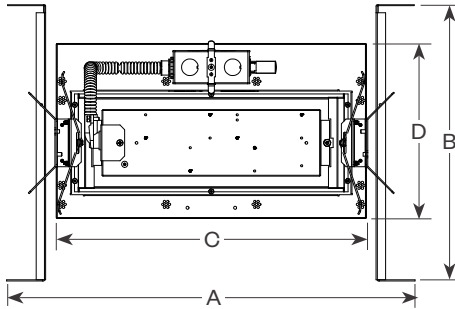

	1 Light	2 Light	3 Light	4 Light
A	12 1/8"	17"	21 1/2"	26"
B	14 1/2"	14 1/2"	14 1/2"	14 1/2"
	max 25"	max 25"	max 25"	max 25"
C	7 1/16"	11 13/16"	16 5/16"	20 13/16"
D	9 1/8"	9 1/8"	9 1/8"	9 1/8"

Ceiling Cut Out: 1 Light - 5 9/16" x 5 9/16"
 2 Light - 5 9/16" x 10 5/16"
 3 Light - 5 9/16" x 14 13/16"
 4 Light - 5 9/16" x 19 5/16"

End View

Standard Driver (ELV/TRIAC)

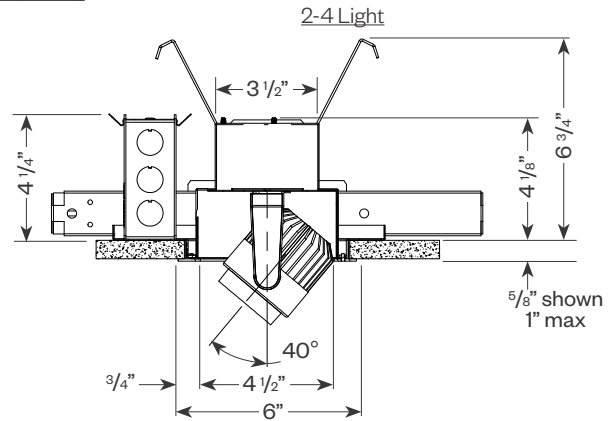
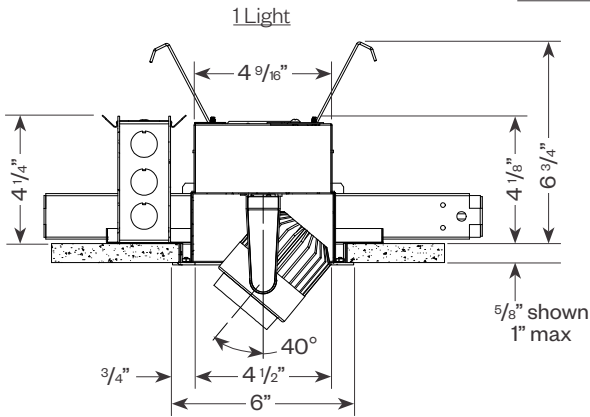

Side View

Standard Driver (ELV/TRIAC)

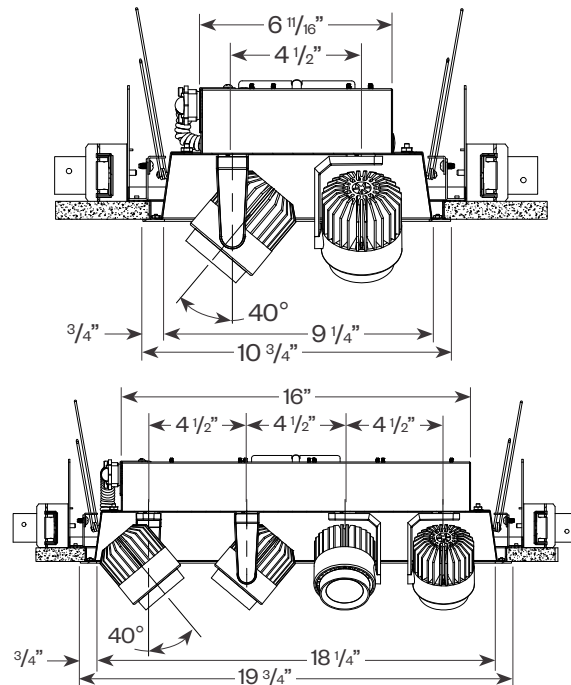
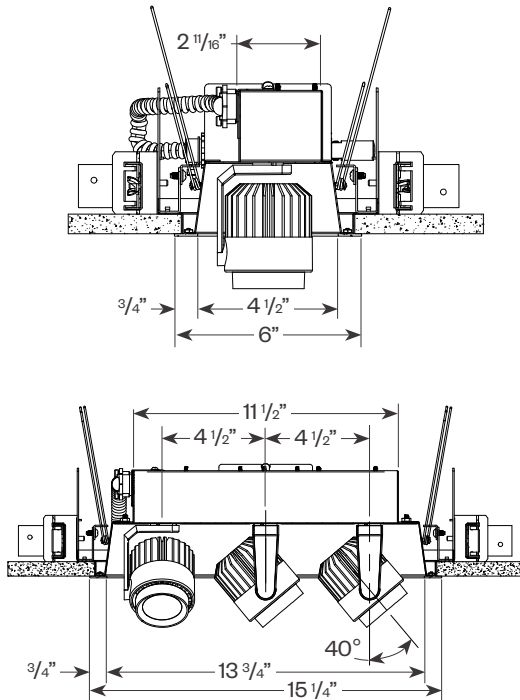

Hornet® HP

Retrofit Multiples



PROJECT:

TYPE:

Product Details - Semi-Recessed Trimmed with Hi-lume®/0-10V/DALI Driver

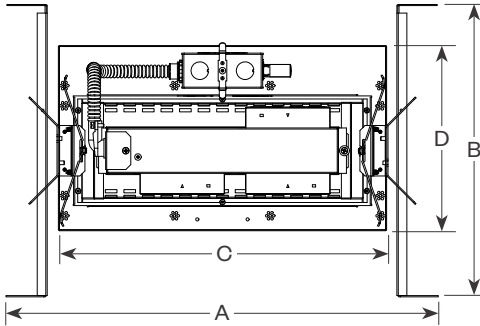

	1 Light	2 Light	3 Light	4 Light
A	12 1/8"	17"	21 1/2"	26"
B	14 1/2"	14 1/2"	14 1/2"	14 1/2"
	max 25"	max 25"	max 25"	max 25"
C	7 1/16"	11 13/16"	16 5/16"	20 13/16"
D	9 1/8"	9 1/8"	9 1/8"	9 1/8"

Ceiling Cut Out: 1 Light - 5 9/16" x 5 9/16"
 2 Light - 5 9/16" x 10 5/16"
 3 Light - 5 9/16" x 14 13/16"
 4 Light - 5 9/16" x 19 5/16"

End View

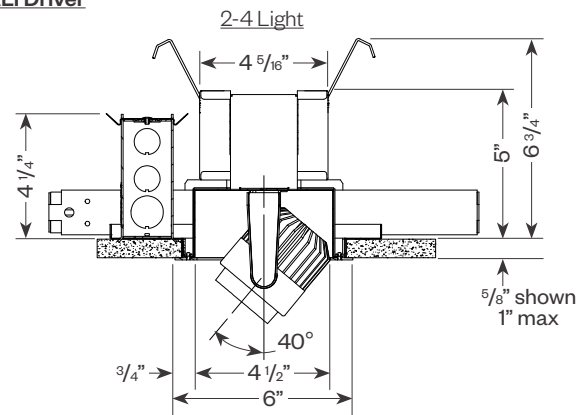
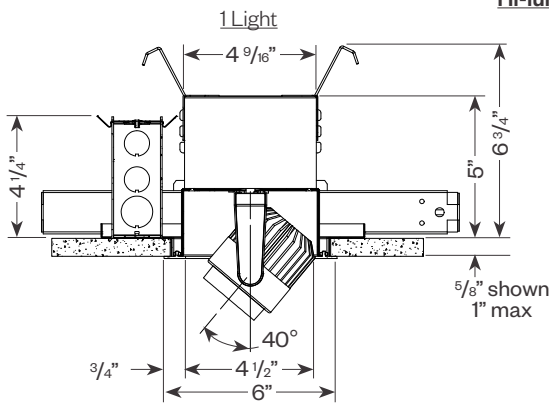

Side View

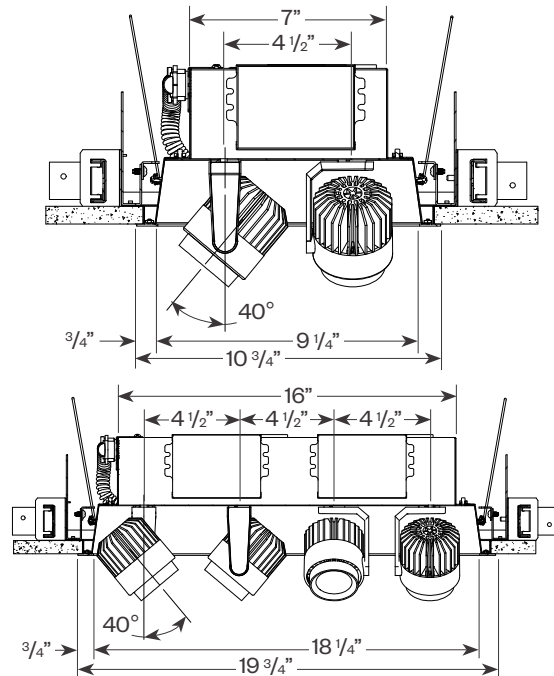
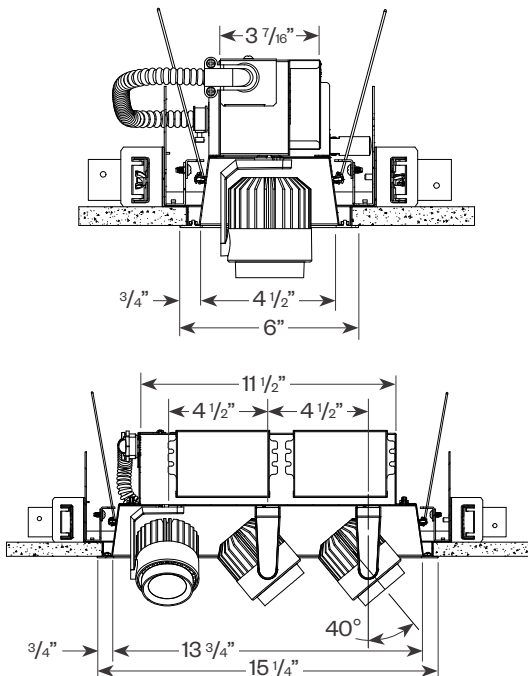

Hornet® HP

Retrofit Multiples



PROJECT:

TYPE:

Product Details - Semi-Recessed Trimless with ELV/TRIAC Driver (see trimless detail on page 4)

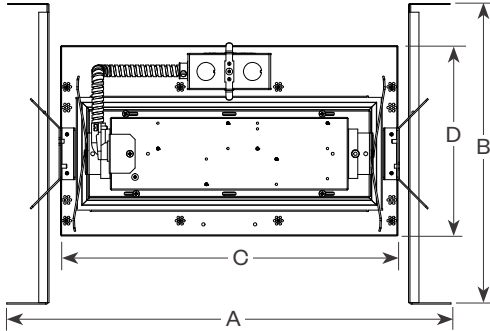

	1 Light	2 Light	3 Light	4 Light
A	12 1/8"	17"	21 1/2"	26"
B	14 1/2"	14 1/2"	14 1/2"	14 1/2"
	max 25"	max 25"	max 25"	max 25"
C	7 1/16"	11 13/16"	16 5/16"	20 13/16"
D	9 1/8"	9 1/8"	9 1/8"	9 1/8"

Ceiling Cut Out: 1 Light - 5 9/16" x 5 9/16"
 2 Light - 5 9/16" x 10 5/16"
 3 Light - 5 9/16" x 14 13/16"
 4 Light - 5 9/16" x 19 5/16"

End View

Standard Driver (ELV/TRIAC)

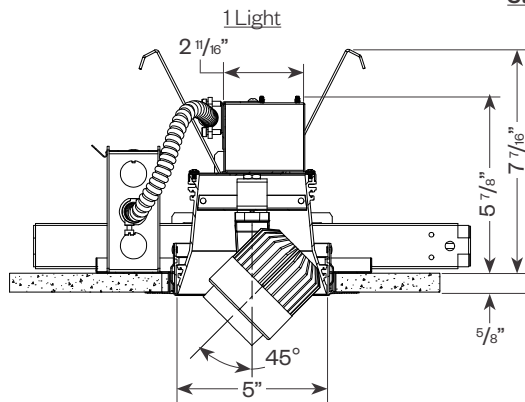

2-4 Light

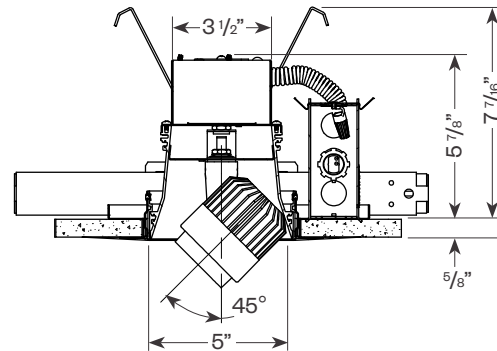

Side View

Standard Driver (ELV/TRIAC)

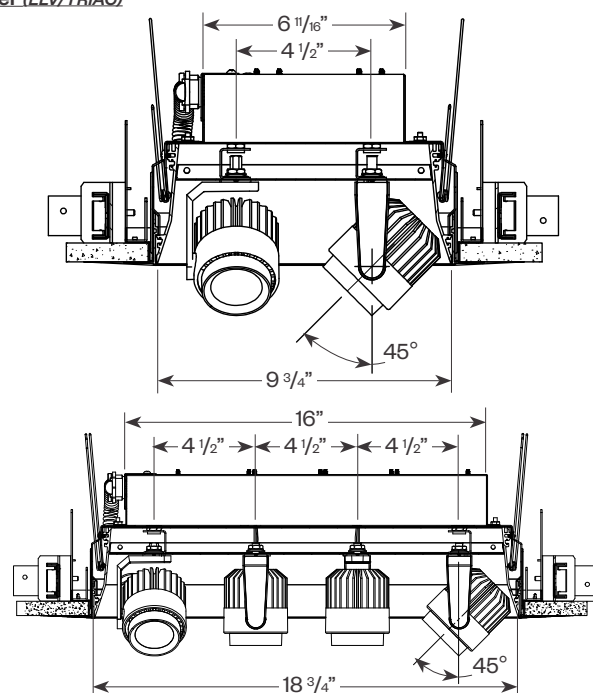
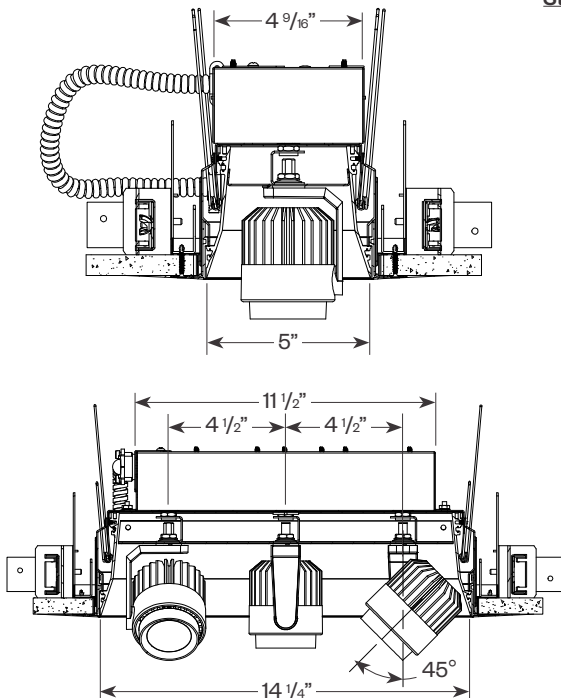

Hornet® HP

Retrofit Multiples



PROJECT:

TYPE:

Product Details - Semi-Recessed Trimless with Hi-lume®/0-10V/DALI Driver (see trimless detail on page 4)

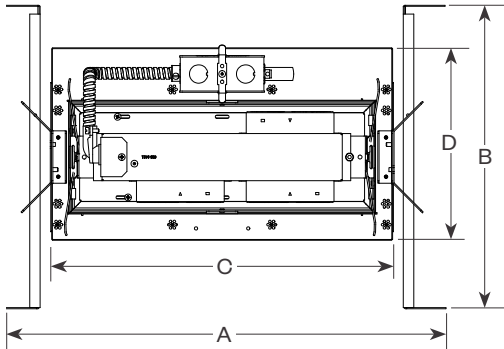

	1 Light	2 Light	3 Light	4 Light
A	12 1/8"	17"	21 1/2"	26"
B	14 1/2"	14 1/2"	14 1/2"	14 1/2"
	max 25"	max 25"	max 25"	max 25"
C	7 1/16"	11 13/16"	16 5/16"	20 13/16"
D	9 1/8"	9 1/8"	9 1/8"	9 1/8"

Ceiling Cut Out:
 1 Light - 5 9/16" x 5 9/16"
 2 Light - 5 9/16" x 10 5/16"
 3 Light - 5 9/16" x 14 13/16"
 4 Light - 5 9/16" x 19 5/16"

End View

Hi-lume®/0-10V/DALI Driver

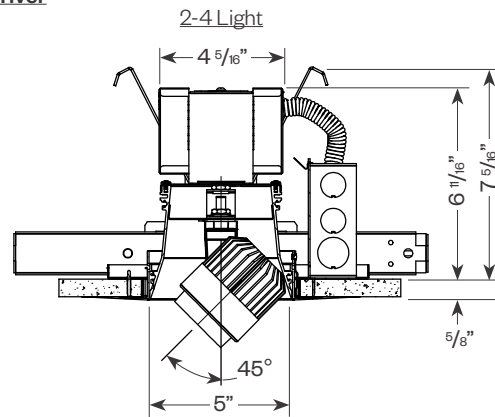
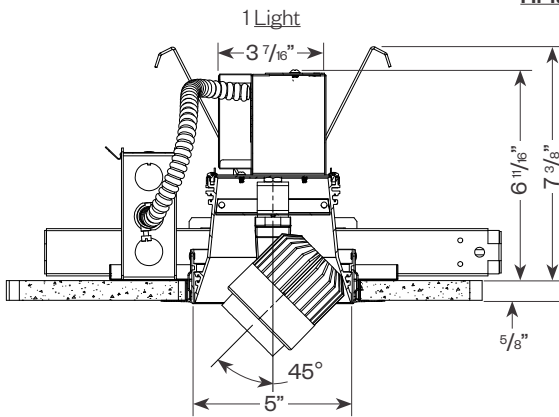

Side View

Hi-lume®/0-10V/DALI Driver

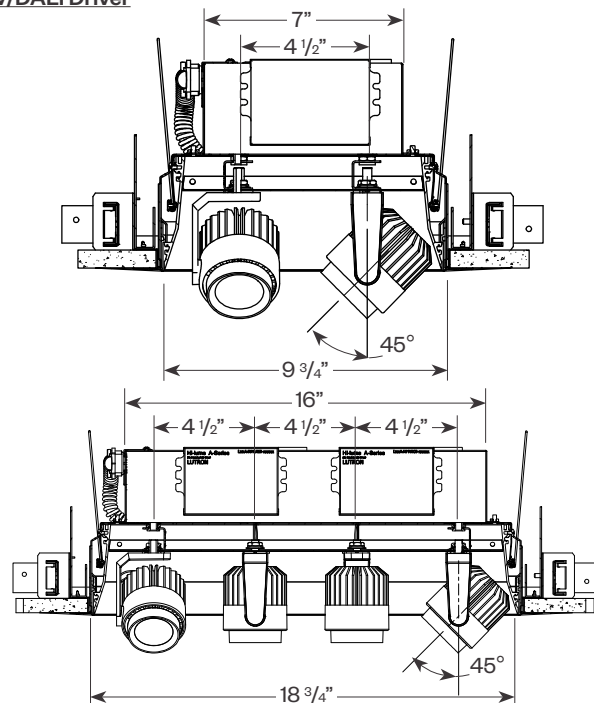
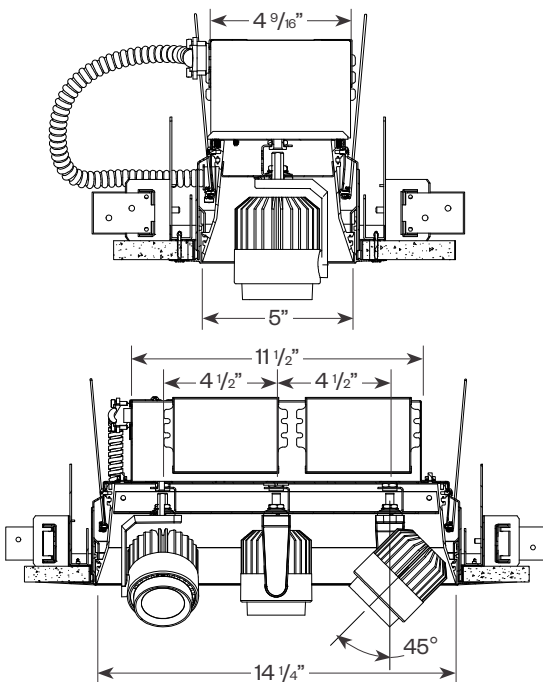

PROJECT:

TYPE:

Performance Data (per head)

Multiplying Factors: (Multiplying Factor is based on 3000K-83 120V IES file on website)

CCT:	2700K-83	3000K-83	3500K-83	4000K-83
Factor:	0.96	1.0	1.02	1.04

Wattage:	11W	16W	18W
Factor:	0.71	1.0	1.13

CCT:	2200K-90+*	2700K-90+	3000K-90+	3500K-90+	4000K-90+	CRISP*	3CLA*
Factor:	0.71	0.80	0.83	0.87	0.90	0.65	0.70

* Not available for use with 18W

16W LED, 3000K-83

Spot (SP) Distribution, 15°
LTL #14346087.01
Lumens: 1,451

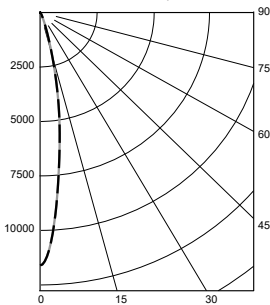

Candelas at Nadir

Deg	Candela
0	11610
5	8378
15	1825
25	257
35	86
45	31

Narrow Flood (NF) Distribution, 22°
LTL #14346087.02
Lumens: 1,390

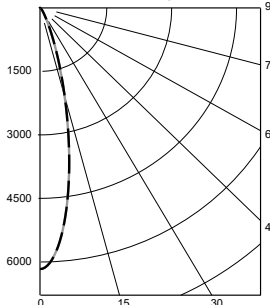

Candelas at Nadir

Deg	Candela
0	6167
5	5391
15	2012
25	426
35	119
45	52

Flood (FL) Distribution, 28°
LTL #14346087.04
Lumens: 1,370

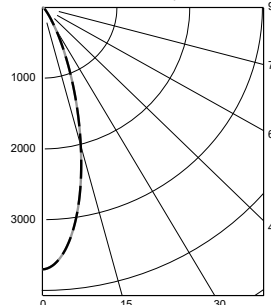

Candelas at Nadir

Deg	Candela
0	3703
5	3440
15	1925
25	651
35	179
45	67

Wide Flood (WF) Distribution, 40°
LTL #14346087.05
Lumens: 1,374

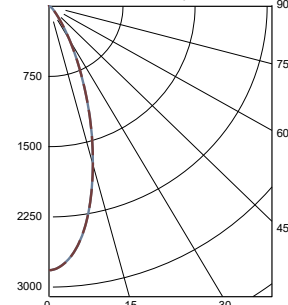

Candelas at Nadir

Deg	Candela
0	2820
5	2674
15	1750
25	763
35	248
45	86

Application Data (per head)

Notes and Definitions:

Beam spread is to 50% center beam candlepower (CBCP).

D=Distance to floor or wall.

FC=Footcandles on floor or wall at center beam aiming location.

L=Effective Visual Beam length in feet (50% of maximum footcandle level).

W=Effective Visual Beam width in feet (50% of maximum footcandle level).

CB=Distance across or down to center beam location.

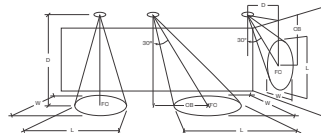

	0° Aiming Angle Horizontal Footcandles				30° Aiming Angle Horizontal Footcandles					30° Aiming Angle Vertical Footcandles					60° Aiming Angle Vertical Footcandles				
	D	FC	L	W	D	FC	L	W	CB	D	FC	L	W	CB	D	FC	L	W	CB
Spot	5.0'	463	1.4	1.4	5.0'	213	2.3	2.2	3.0	3.0'	135	3.4	2.2	5.0	3.0'	403	1.8	1.6	2.0
	7.5'	206	2.1	2.1	7.5'	110	3.3	2.9	4.0	4.0'	87	4.2	2.6	6.0	4.0'	295	2.1	1.8	2.0
	10.0'	116	2.9	2.9	10.0'	64	4.3	3.7	5.0	5.0'	58	5.2	3.2	8.0	5.0'	205	2.5	2.2	3.0
	12.5'	74	3.6	3.6	12.5'	44	5.1	4.5	7.0	6.0'	42	6.2	3.6	9.0	6.0'	152	2.8	2.5	3.0
Narrow Flood	5.0'	247	1.9	1.9	5.0'	133	2.9	2.7	3.0	3.0'	97	3.7	2.4	4.0	3.0'	280	2.1	1.8	2.0
	7.5'	110	3.0	3.0	7.5'	67	4.0	3.6	4.0	4.0'	57	4.8	3.1	5.0	4.0'	201	2.4	2.2	2.0
	10.0'	62	3.9	3.9	10.0'	40	5.2	4.6	5.0	5.0'	39	5.7	3.6	7.0	5.0'	131	3.0	2.7	3.0
	12.5'	40	5.0	5.0	12.5'	26	6.4	5.7	6.0	6.0'	28	6.9	4.3	8.0	6.0'	99	3.4	3.0	3.0
Flood	5.0'	168	2.5	2.5	5.0'	86	3.6	3.2	2.0	3.0'	70	3.9	2.9	4.0	3.0'	194	2.4	2.2	2.0
	7.5'	72	3.7	3.7	7.5'	42	5.0	4.6	4.0	4.0'	43	5.1	3.5	5.0	4.0'	138	2.8	2.7	2.0
	10.0'	40	5.0	5.0	10.0'	25	6.5	5.9	5.0	5.0'	28	6.2	4.4	6.0	5.0'	87	3.6	3.2	2.0
	12.5'	25	6.3	6.3	12.5'	16	8.2	7.4	6.0	6.0'	20	7.5	5.2	7.0	6.0'	65	4.0	3.7	3.0
Wide Flood	5.0'	113	3.0	3.0	5.0'	71	3.9	3.5	2.0	3.0'	60	4.1	3.1	3.0	3.0'	156	2.7	2.5	2.0
	7.5'	50	4.5	4.5	7.5'	34	5.5	5.1	3.0	4.0'	36	5.3	3.9	4.0	4.0'	110	3.1	3.0	2.0
	10.0'	28	6.0	6.0	10.0'	19	7.4	6.8	5.0	5.0'	24	6.4	4.8	5.0	5.0'	72	3.9	3.5	2.0
	12.5'	18	7.5	7.5	12.5'	13	9.1	8.4	6.0	6.0'	17	7.7	5.7	7.0	6.0'	52	4.5	4.2	3.0

PROJECT:

TYPE:

Dimming Compatibility

Amerlux® Hornet® fixtures are compatible with all major dimming protocols prevalent in the United States. Please see below for general compatibilities and wiring diagrams. Amerlux recommends testing your unique dimming configuration as the exact full configuration (*Dimmer, Fixture Quantity, Voltage, etc*) may affect dimming performance.

--- NOTE: INFORMATION BELOW IS FOR WIRED DIMMERS ONLY. FOR WIRELESS DIMMERS, CONSULT FACTORY ---

TRIAC (Forward Phase) Dimming

Utilizes standard TRIAC dimmers that are in wide use in installations across the US. Best for retrofit applications where TRIAC dimmers are installed.

Notes:

- 120VAC or 277VAC*
- Dims down to 5% light output (*most cases*)
- Consult Dimming manufacturer for installation instructions - **DO NOT SHARE NEUTRALS!**
- Must meet dimmer Minimum Load Requirements per dimming manufacturer

TRIAC Wiring Diagram

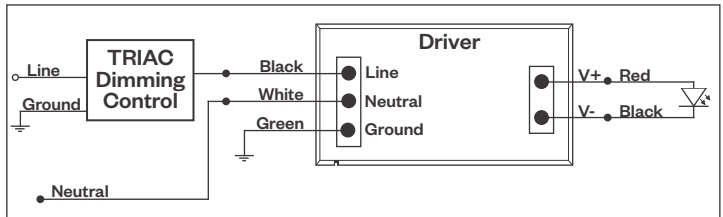

Compatible Dimmers†:	
Wall Box (TRIAC 120VAC)	Central System
Lutron "Diva"	Lutron "GP" Panel
Lutron "Nova-T"	Lutron Grafik Eye QS
Lutron "Maestro"	
Lutron "Skylark"	

ELV - Electronic Low Voltage (Reverse Phase) Dimming

Utilizes specialized "ELV" dimmers.

Notes:

- 120VAC or 277VAC*
- Dims down to 5% light output (*most cases*)
- Consult Dimming manufacturer for installation instructions - **DO NOT SHARE NEUTRALS!**
- Must meet dimmer Minimum Load Requirements per dimming manufacturer

ELV Wiring Diagram

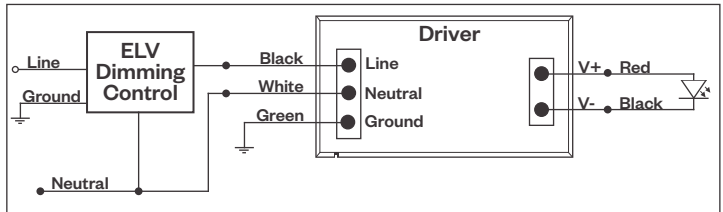

Compatible Dimmers†:		
Wall Box (ELV 120VAC)	Wall Box (ELV 277VAC)	Central System
Lutron "Diva"	Leviton Revoir II AWSMT-E	Lutron "GP" Panel with PHPM-PA 120/277VAC
Lutron "Nova-T"		Lutron Grafik Eye QS with PHPM-PA 120/277VAC
Lutron "Maestro"		
Lutron "Skylark"		
Leviton "Surslide"		
Leviton "Vizio"		

Notes:

* Driver is 277VAC dimmable with appropriate dimmer (*by others*). All provided wiring diagrams show 120VAC wiring colors and method. Please refer to 277VAC dimmer installation instructions for 277VAC wiring diagrams.

† The absence of a dimmer from the lists above does not imply incompatibility. Please consult factory for compatibility inquiries.

PROJECT:

TYPE:

Dimming Compatibility *(continued)*

Amerlux® Hornet® fixtures are compatible with all major dimming protocols prevalent in the United States. Please see below for general compatibilities and wiring diagrams. Amerlux recommends testing your unique dimming configuration as the exact full configuration (*Dimmer, Fixture Quantity, Voltage, etc*) may affect dimming performance.

--- NOTE: INFORMATION BELOW IS FOR WIRED DIMMERS ONLY. FOR WIRELESS DIMMERS, CONSULT FACTORY ---

0-10V Dimming

Integrates into a variety of building management and daylighting controls

Notes:

- 120VAC or 277VAC*
- Dims down to 1% light output
- Requires interface to turn off power to driver
- Consult Dimming manufacturer for installation instructions - **DO NOT SHARE NEUTRALS!**

0-10V Wiring Diagram

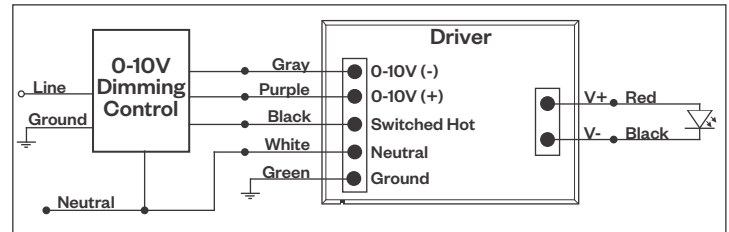

Compatible Dimmers*:

Wall Box

Central System

Lutron "Diva" - DVSTV	Leviton Renoir II 0-10V	Lutron Grafik Eye with GRX-TVI Interface
-----------------------	-------------------------	--

Lutron LDE1 Dimming

Integrates into Lutron EcoSystem building management

Notes:

- 120VAC or 277VAC*
- Dims down to 1% Soft-On/Fade-to-Black
- EcoSystem Control
- Consult Dimming manufacturer for installation instructions - **DO NOT SHARE NEUTRALS!**

LDE1 (HILUME-H-ECO) EcoSystem Digital Control Wiring Diagram

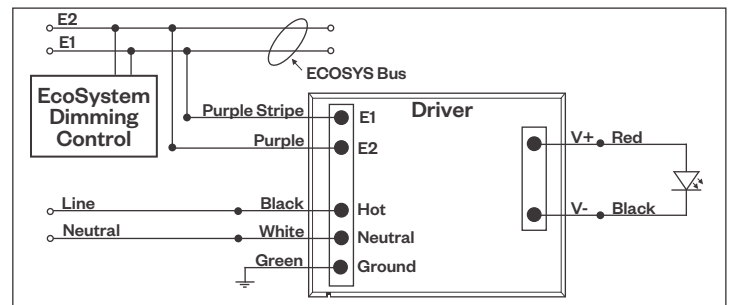

Compatible Dimmers*:

Lutron ECO System

Central System

Pow Pak Dimming Modules	Lutron EcoSystem compatible controls
Energi Savr Node	
Grafik Eye QS/Homeworks	
QS Control Unit	
Quantum Hub	
Homeworks QS/My Room	

DALI Dimming

Digital control protocol allows individual fixture control

Notes:

- 120VAC - 277VAC*
- Dims down to 1% light output in most cases

DALI Wiring Diagram

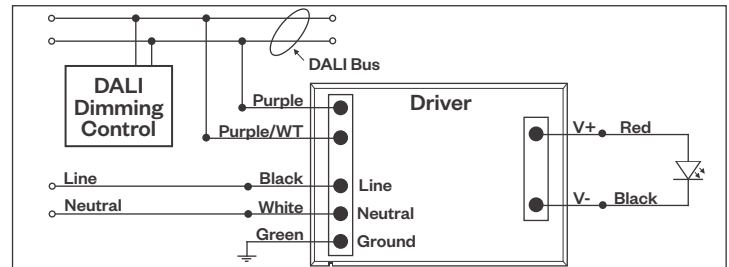

Compatible Dimmers*:

Wall Box (3-Wire Fluorescent)

Central System

Leviton CD250 Controller	Dynalite
	Fifth Light

Notes:

* Driver is 277VAC dimmable with appropriate dimmer (*by others*). All provided wiring diagrams show 120VAC wiring colors and method. Please refer to 277VAC dimmer installation instructions for 277VAC wiring diagrams.

† The absence of a dimmer from the lists above does not imply incompatibility. Please consult factory for compatibility inquiries.