

# HORNET® HP DOWNLIGHT

3.5" ROUND PINHOLE ADJUSTABLE SLOT LED INTERNATIONAL

I-HDL-HP-  
RPAS-A14  
LED



**APPLICATIONS:**

Retail and commercial accent & display lighting

**CONSTRUCTION:**

Die-cast aluminum trim ring  
Die-cast optical head construction  
Spring steel retaining clips  
Formed steel faceplate

**ELECTRICAL:**

Electronic constant current LED driver, 240v input  
ELV & Triac dimming standard  
**This product complies with IEEE C62.41 for surge endurance up to 2.5KV. Amerlux® recommends using additional surge protection with this unit (supplied by others), surge damage is not covered by warranty.**

**OPTICS:**

LED:  
Color Temp Options: 2200K, 2700K, 3000K, 3500K, 4000K  
CRI: 83 typ. (2700K, 3000K, 3500K, 4000K)  
90+ typ. (2200K, 2700K, 3000K)  
Optional Amerlux CrispWhite technology (16W max)  
R9 Value: 11 (83CRI), 55 (90+CRI)  
Binning: 3 MacAdam (SDMC)  
Lumen Maintenance: >70% of initial lumens @ 50,000 hrs  
Lumen Output (at 3000K):  
16W: SP 914 typ      18W: SP 1016 typ  
          NF 818 typ      NF 909 typ  
          MFL 766 typ     MFL 851 typ  
          FL 750 typ      FL 833 typ  
0-30° tilt, 358° rotation

**LABELING:**

**CE**  
For indoor use only

PROJECT:

TYPE:

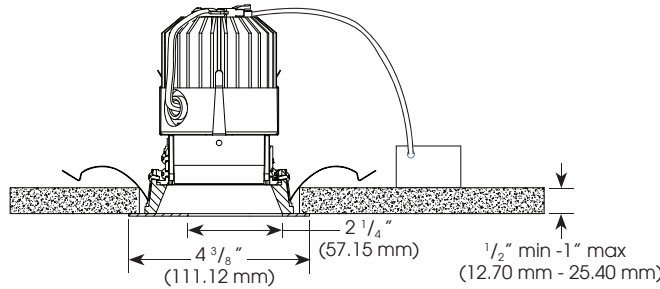
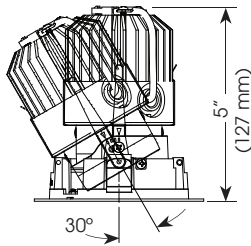

Celling Cut Out Dimension: 3 55/64" (98 mm)

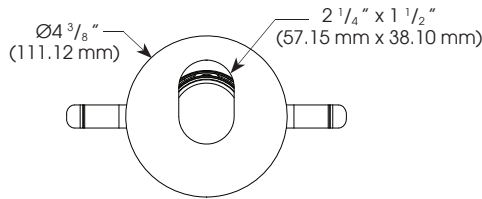

  
Electrostatic sensitive device,  
observe precautions for  
handling

  
98 mm

**ELECTRICAL**

Electronic driver

240v	11W		16W		18W	
	System Watts	Amps	System Watts	Amps	System Watts	Amps
	11	0.05	16	0.07	18	0.08

**3 year limited warranty**  
AMERLUX INTERNATIONAL  
(see website for details)

**ORDERING INFORMATION:**

Model	Wattage	Lamp Type	Voltage	Trim Finish	Beam Spread	Color Temp (CCT-CRI)	Listing Code	Options/Accessories
HDL-HP-RPAS-A14	11	LED	240	MW - matte white	SP - spot, 15°	27 - 2700K-83	CE	HEX - hexcell louver
	16			MB - matte black	NF - narrow flood, 20°	30 - 3000K-83		SOL - solite beam
	18			SLV - matte silver	MFL - medium flood, 24°	35 - 3500K-83		softening lens
			PC - polished chrome	FL - flood, 28°	40 - 4000K-83		DALI - DALI driver	
			BSS - brushed stainless steel			229 - 2200K-90+		
						279 - 2700K-90+		
						309 - 3000K-90+		
						CRISP - CrispWhite (16W max)		
						3CLA - 3K Class A		

Example: HDL-HP-RPAS-A14-18-LED-120-MW-FL-30-CE

Cat #:

Amerlux reserves the right to change details that do not affect overall function and performance.



# HORNET® HP DOWNLIGHT

3.5" ROUND PINHOLE ADJUSTABLE SLOT LED INTERNATIONAL

I-HDL-HP-  
RPAS-A14  
LED



TYPE:



**FIXTURE DATA:** For 11W data, multiply by 0.62; For 16W data, multiply by 0.88

Complete photometric data (ies format) available upon request.

CCT Conversion Factor: 2700K-83 = 0.96; 3500K-83 = 1.02; 4000K-83 = 1.04; 2200K-90+ = 0.71; 2700K-90+ = 0.80; 3000K-90+ = 0.83; CRISP = 0.65; 3CLA = 0.75

## 18W LED 3000K-83

SPOT  
DISTRIBUTION  
LTL # 818220

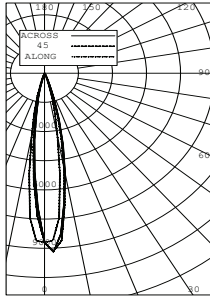

Candelas at Nadir	
Deg	Candela
0	8708
5	7439
15	1282
25	33
35	5
45	0

NARROW FLOOD  
DISTRIBUTION  
LTL # 818221

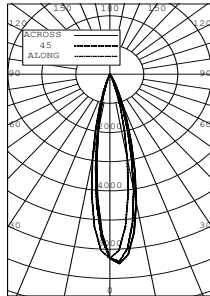

Candelas at Nadir	
Deg	Candela
0	6311
5	5258
15	1202
25	62
35	7
45	0

MEDIUM FLOOD  
DISTRIBUTION  
LTL # 818222

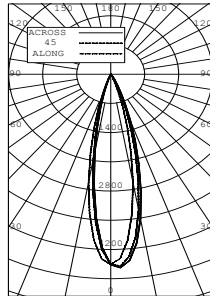

Candelas at Nadir	
Deg	Candela
0	4560
5	3994
15	1320
25	116
35	8
45	0

FLOOD  
DISTRIBUTION  
LTL # 818223

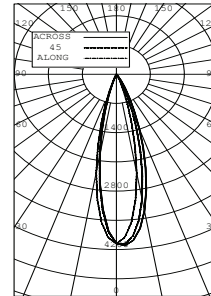

Candelas at Nadir	
Deg	Candela
0	4055
5	3556
15	1218
25	113
35	8
45	0

## APPLICATION DATA:

### Notes and Definitions:

Beam spread is to 50% center beam candlepower (CBCP).  
 D=Distance to floor or wall.  
 FC=Footcandles on floor or wall at center beam aiming location.  
 L=Effective Visual Beam length in feet (50% of maximum footcandle level).  
 W=Effective Visual Beam width in feet (50% of maximum footcandle level).  
 CB=Distance across or down to center beam location.

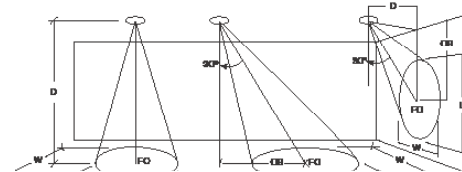

0° Aiming Angle  
Horizontal  
Footcandles

	D	FC	L	W
SPOT	5.0'	233	2.0	1.9
	7.5'	127	2.6	2.6
	10.0'	77	3.3	3.3
	12.5'	52	4.0	4.0
NARROW FLOOD	5.0'	180	2.2	2.0
	7.5'	94	2.9	2.8
	10.0'	57	3.8	3.6
	12.5'	38	4.6	4.5
MEDIUM FLOOD	5.0'	140	2.3	2.3
	7.5'	71	3.3	3.1
	10.0'	42	4.3	4.1
	12.5'	28	5.2	5.2
FLOOD	5.0'	127	2.5	2.3
	7.5'	64	3.6	3.2
	10.0'	38	4.6	4.2
	12.5'	25	5.8	5.4