

# HORNET® HP DOWNLIGHT

3.5" ROUND ADJUSTABLE TRIMLESS LED INTERNATIONAL

I-HDL-HP-RA-A14-TL  
LED



**APPLICATION:**

Retail, commercial & hospitality accent/display lighting

**CONSTRUCTION:**

Die-cast aluminum trim ring  
Die-cast optical head construction  
Cast aluminum plaster frame with perforated face  
Spring steel retaining clips  
Painted finishes include matte white and optical matte black

**ELECTRICAL:**

Electronic constant current LED driver, 240v  
ELV & Triac dimming standard

**This product complies with IEEE C62.41 for surge endurance up to 2.5KV. Amerlux® recommends using additional surge protection with this unit (supplied by others), surge damage is not covered by warranty.**

**OPTICS:**

Available in a variety of beam spreads  
LED:

Color Temp Options: 2200K, 2700K, 3000K, 3500K, 4000K  
CRI: 83 typ. (2700K, 3000K, 3500K, 4000K)  
90+ typ. (2200K, 2700K, 3000K)

Optional Amerlux CrispWhite technology (16W max)  
R9 Value: 11 (83CRI), 55 (90+CRI)

Binning: 3 MacAdam (SDMC)  
Lumen Maintenance: >70% of initial lumens @ 50,000 hrs

Lumen Output (at 3000K):  
16W:SP 1199 typ      18W:SP 1332 typ  
          NF 1114 typ      NF 1238 typ  
          FL 1074 typ      FL 1193 typ  
          WF 1024 typ      WF 1138 typ

0-30° tilt, 358° rotation

**LABELING:**



For indoor use only

**PROJECT:**  
  
**TYPE:**

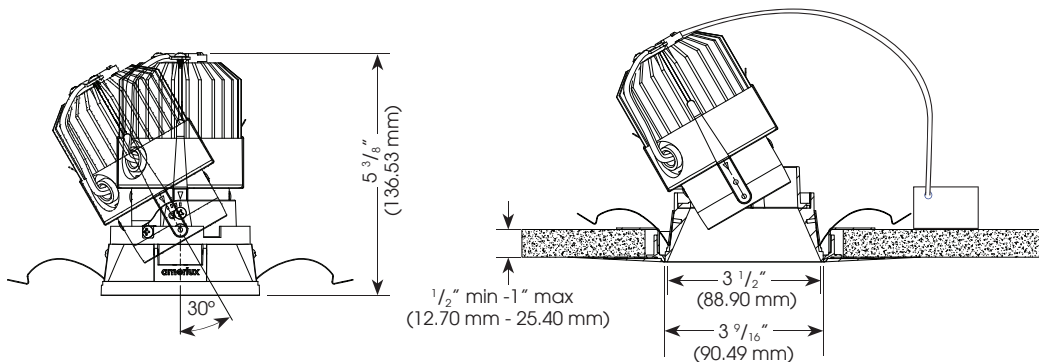

Ceiling Cut Out Dimension: 4 1/2" (114.3 mm)

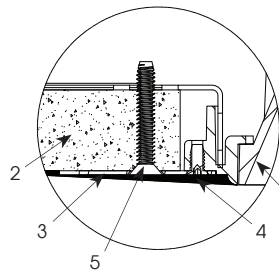

1. Reflector Trim
2. Ceiling 1/2" (1" Max.)
3. Cast Aluminum Plaster Frame
4. Plaster Skim Coat (By Others)
5. #6 Screw (by others)



114.3 mm

**ELECTRICAL**

Electronic driver

240v	11W		16W		18W	
	System Watts	Amps	System Watts	Amps	System Watts	Amps
	11	0.05	16	0.07	18	0.08

**ORDERING INFORMATION:**

Model	Wattage	Lamp Type	Voltage	Aperture Finish	Beam Spread	Color Temp (CCT-CRI)	Listing Code	Options/Accessories
I-HDL-HP-RA-A14-TL	11 16 18	LED	240	MB - matte black MW - matte white SLV - matte silver	SP - spot, 15° NF - narrow flood, 20° MFL - medium flood, 24° FL - flood, 28° WF - wide flood, 45° VWF - very wide flood, 60° LS - linear spread, 60° x 10°	27 - 2700K-83 30 - 3000K-83 35 - 3500K-83 40 - 4000K-83  229 - 2200K-90+ 279 - 2700K-90+ 309 - 3000K-90+  CRISP - CrispWhite (16W max) 3CLA - 3K Class A	CE	HEX - hexcell louver SOL - solite beam softening lens DALI - DALI driver

Example: I-HDL-HP-RA-A14-TL-18-LED-240-MB-FL-30-CE

Cat #:

Amerlux reserves the right to change details that do not affect overall function and performance.



**3 year limited warranty**  
AMERLUX INTERNATIONAL  
(see website for details)

# HORNET® HP DOWNLIGHT

3.5" ROUND ADJUSTABLE TRIMLESS LED INTERNATIONAL

I-HDL-HP-RA-A14-TL  
LED



TYPE:



**FIXTURE DATA:** For 11W data, multiply by 0.62; For 16W data, multiply by 0.88

Complete photometric data (ies format) available upon request.

CCT Conversion Factor: 2700K-83 = 0.96; 3500K-83 = 1.02; 4000K-83 = 1.04; 2200K-90+ = 0.71; 2700-90+ = 0.80; 3000K-90+ = 0.83; CRISP = 0.65; 3CLA = 0.75

## 18W LED 3000K-83

SPOT  
DISTRIBUTION  
LTL # 818224

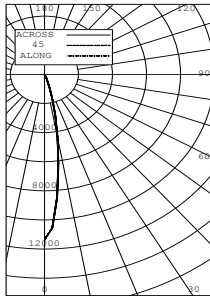

Candelas at Nadir	
Deg	Candela
0	11367
5	8488
15	1846
25	199
35	38
45	3

NARROW FLOOD  
DISTRIBUTION  
LTL # 818225

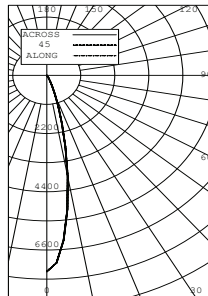

Candelas at Nadir	
Deg	Candela
0	7412
5	6254
15	1895
25	288
35	49
45	4

FLOOD  
DISTRIBUTION  
LTL # 818227

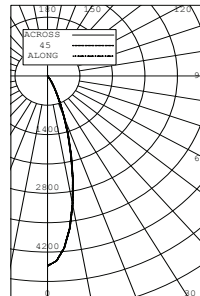

Candelas at Nadir	
Deg	Candela
0	4527
5	4117
15	1963
25	488
35	77
45	5

WIDE FLOOD  
DISTRIBUTION  
LTL # 818228

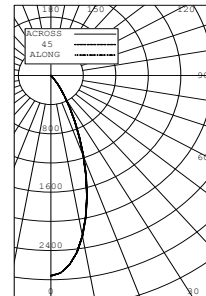

Candelas at Nadir	
Deg	Candela
0	2747
5	2609
15	1715
25	693
35	149
45	8

## APPLICATION DATA:

### Notes and Definitions:

Beam spread is to 50% center beam candlepower (CBCP).  
 D=Distance to floor or wall.  
 FC=Footcandles on floor or wall at center beam aiming location.  
 L=Effective Visual Beam length in feet (50% of maximum footcandle level).  
 W=Effective Visual Beam width in feet (50% of maximum footcandle level).  
 CB=Distance across or down to center beam location.

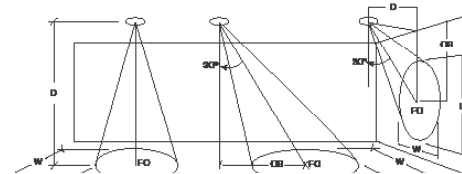

0° Aiming Angle  
Horizontal  
Footcandles

	D	FC	L		W	
			Horizontal	Vertical	Horizontal	Vertical
SPOT	5.0'	286	1.9	1.9	1.9	1.9
	7.5'	157	2.7	2.7	2.7	2.7
	10.0'	97	3.3	3.3	3.3	3.3
	12.5'	65	3.9	3.9	3.9	3.9
NARROW FLOOD	5.0'	215	2.2	2.2	2.2	2.2
	7.5'	112	3.0	3.0	3.0	3.0
	10.0'	67	3.8	3.8	3.8	3.8
	12.5'	44	4.7	4.7	4.7	4.7
FLOOD	5.0'	148	2.7	2.7	2.7	2.7
	7.5'	73	3.7	3.7	3.7	3.7
	10.0'	43	4.8	4.8	4.8	4.8
	12.5'	28	5.9	5.9	5.9	5.9
WIDE FLOOD	5.0'	97	3.2	3.2	3.2	3.2
	7.5'	46	4.6	4.6	4.6	4.6
	10.0'	26	6.1	6.1	6.1	6.1
	12.5'	17	7.6	7.6	7.6	7.6