

# Acion

## Small LED Accent



ACCS.x.x.BLK

### Features

The Amerlux Acion accent luminaire employs solid state technology and precision engineering to provide small scale LED solutions in landscape and architectural layouts. All components are encapsulated inside a single attractive enclosure designed for superior performance in weather resistant applications. Offered in a choice of beam spreads, finishes, and color temperatures, two mounting options and glare shield are also available.

### Product Overview

Type:	Exterior Accent
Wattage:	10W
Lumen Output :	710 lm
Color Temp:	2700K, 3000K, 3500K, 4000K
Dimming:	ELV trailing edge dimming only

### PROJECT:

### TYPE:

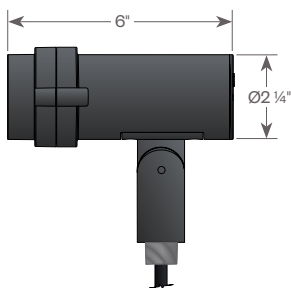
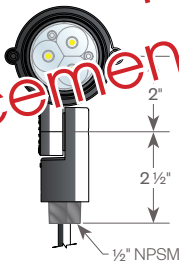

Replacement Product: Rook X Adjustable Accent

PRODUCT DISCONTINUED

#### Application:

Exterior accent lighting for landscapes, including small signs and features.

#### Construction:

- Die-cast aluminum
- IP67 sealed optical chamber and integral driver chamber
- Easy “two-screw” integral driver access, does not disturb optical chamber seal
- Flush lens prevents puddles/water deposits in upward facing applications
- 180° Knuckle mount
- Vertical aiming lock, with tamper-resistant tooled locking after final aiming

#### Optics:

- Lumen maintenance: 70% @ 50,000 hours
- 10°, 15°, 30°, 40°, 60°, 60x10, 60x30, 90x60 beam spreads are available with secondary shaping lens

#### Electrical:

- Integral driver
- Input voltage 120V-277V auto-sensing
- 1/2" NPSM wire entry
- Drive current 700mA
- Power consumption 10W
- ELV trailing edge dimming only

**ETL listed, suitable for wet locations.**

#### Mounting Accessories:

- (order separately)
- Ground Stake (**GSP17**)
  - Junction Box (**JBOX**)
  - Junction Mount (**JCOV**)

#### Optical Accessories:

- Hexcell Louver (**HCS**)
- Half Glare Shield (**HGS**)

#### Finish:

Premium quality thermoset polyester powdercoat for a durable finish.



**5** year limited warranty  
AMERLUX LED



**PROJECT:**

**TYPE:**

**Luminaire Ordering Information**

**ACCS**

- 1**
- 2**
- 3**
- 4**
- 5**

- 1** Model  
**ACCS**
- 2** Color Temp  
27 - 2700K  
30 - 3000K  
35 - 3500K  
40 - 4000K
- 3** Beam Spread  
10 - 10°  
15 - 15°  
30 - 30°  
40 - 40°  
60 - 60°  
H6010 - 60° x 10°  
H6030 - 60° x 30°  
H9060 - 90° x 60°  
V6010 - 60° x 10°  
V6030 - 60° x 30°  
V9060 - 90° x 60°
- 4** Finish  
BLK - Satin Black  
CLB - Classic Bronze  
GRN - Green  
WHT - White  
CSTM - Custom
- 5** Optical Accessories  
HCS - Hexcell Louver  
HGS - Half Glare Shield

**Mounting Accessories Ordering Information** (order separately)

- 1**
- 2**

- 1** Mounting Accessories  
GSP17 - Ground Stake (black polycarbonate)  
JBOX - Junction Box (finish matches fixture finish)  
JCOV - Junction Mount (finish matches fixture finish)
- 2** Finish  
BLK - Satin Black  
CLB - Classic Bronze  
GRN - Green  
WHT - White  
CSTM - Custom

**PROJECT:**

**TYPE:**

**Optical Accessories**

**HGS**  
(Half Glare Shield)

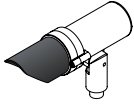

**HCS**  
(Hexcell Louver)

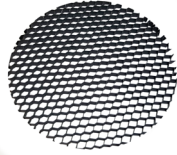

**Mounting Accessories (order separately)**

**GSP17**  
(Ground Stake)

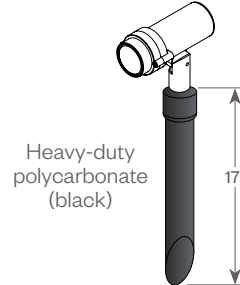

**JCOV**  
(Junction Mount)

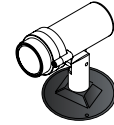

**JBOX**  
(Junction Box)



Finish will match luminaire color

**Optical Performance - Polar Graphs**

**ACCS-27-10**

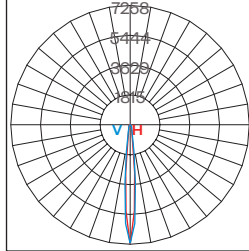

Maximum Candela = 7258  
Horizontal Beam Angle(50%) = 11  
Vertical Beam Angle(50%) = 11  
Horizontal Field Angle (10%) = 21  
Vertical Field Angle (10%) = 22

**ACCS-27-30**

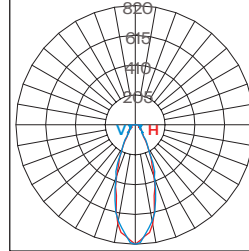

Maximum Candela = 820  
Horizontal Beam Angle(50%) = 38  
Vertical Beam Angle(50%) = 36  
Horizontal Field Angle (10%) = 77  
Vertical Field Angle (10%) = 76

**ACCS-27-40**

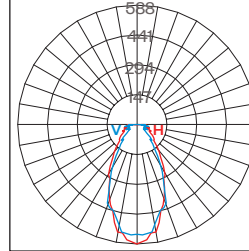

Maximum Candela = 588  
Horizontal Beam Angle(50%) = 47  
Vertical Beam Angle(50%) = 46  
Horizontal Field Angle (10%) = 92  
Vertical Field Angle (10%) = 130

**ACCS-27-60**

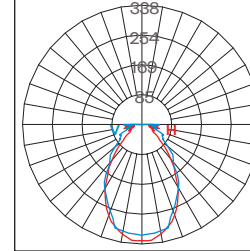

Maximum Candela = 388  
Horizontal Beam Angle(50%) = 70  
Vertical Beam Angle(50%) = 66  
Horizontal Field Angle (10%) = 148  
Vertical Field Angle (10%) = 142

**ACCS-27-60X10**

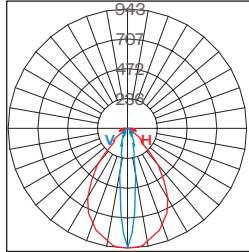

Maximum Candela = 943  
Horizontal Beam Angle(50%) = 66  
Vertical Beam Angle(50%) = 18  
Horizontal Field Angle (10%) = 98  
Vertical Field Angle (10%) = 52

**ACCS-27-60X30**

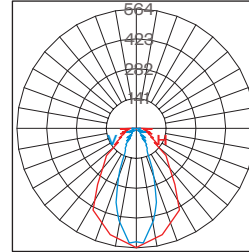

Maximum Candela = 564  
Horizontal Beam Angle(50%) = 65  
Vertical Beam Angle(50%) = 35  
Horizontal Field Angle (10%) = 115  
Vertical Field Angle (10%) = 99

**ACCS-27-90X60**

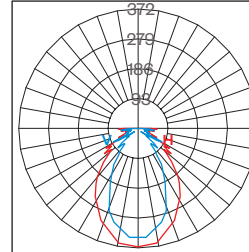

Maximum Candela = 372  
Horizontal Beam Angle(50%) = 78  
Vertical Beam Angle(50%) = 66  
Horizontal Field Angle (10%) = 152  
Vertical Field Angle (10%) = 142

NOTE: Data represents the use of light shaping filters.  
Complete photometric data (ies format) available upon request.

**Performance Chart**

Pattern	Beam Spread	Approx. Lumens	Total Efficacy
Symmetrical	<b>10</b> (10°)	630-710	63-71 lm/W
	<b>15</b> (15°)	600-680	60-68 lm/W
	<b>30</b> (30°)	570-650	57-65 lm/W
	<b>40</b> (40°)	570-650	57-65 lm/W
	<b>60</b> (60°)	540-620	54-62 lm/W
Horizontal	<b>H6010</b> (60°x10°)	630-570	63-57 lm/W
	<b>H6030</b> (60°x30°)	570-590	57-59 lm/W
	<b>H9060</b> (90°x60°)	580-610	58-61 lm/W
Vertical	<b>V6010</b> (60°x10°)	630-570	63-57 lm/W
	<b>V6030</b> (60°x30°)	570-590	57-59 lm/W
	<b>V9060</b> (90°x60°)	580-610	58-61 lm/W