

Rook X Accent

2" Exterior Adjustable Accent



PROJECT:

TYPE:

Features

The Rook X takes Adjustable lighting to next level. The family employs solid state technology and precision engineering to provide small scale, but powerful LED solution for landscape, architectural and even post mounted layouts. All components are encapsulated inside a single attractive enclosure designed for superior performance in weather resistant applications. Offered in a choice of beam spreads, finishes, and color temperatures. Two mounting options, and several glare shields are also available. Various optical accessories, beam shaping films or a hexcell louver can be changed or added in the field.

Product Overview

Type:	Exterior Adjustable Accent
Wattage:	12W
Color Temp:	2700K, 3000K, 3500K, 4000K
CRI:	83 typ. or 90+ typ.
Dimming:	Integrated driver with 3 dimming protocols is standard (TRIAC & ELV or 0-10V), 120-277V
Operating Temp:	-40°C to +40°C



RKX-AS



RKX-AR

Certifications



Fixture Summary

Application:

Exterior accent lighting for landscape, hardscape, buildings, signage or pole mount.

Construction:

- Machined aluminum housing and die-cast knuckle assembly
- IP66 sealed optical chamber and integral driver chamber
- Flush lens prevents puddles/water deposits in upward facing applications
- 180°+ adjustability in the knuckle
- Infinitely adjustable within the vertical aiming range using tapered locking mechanism.

Optics:

- 17°, 22°, 28°, 45°, 60°, 60x20, 90x60 90x60 beam spreads are available with secondary shaping lens

Electrical:

- Integral tri-dim driver
- Input voltage 120V-277V auto-sensing
- Drive current 300mA
- Power consumption 12W

Mounting:

- 1/2" NPT internal threads on the adjustable knuckle
- Supplied with 1/2" NPT to 1/2" NPSM externally threaded stainless steel nipple for mounting to various accessories

Mounting Accessories:

(ordered separately)

- Ground Stake
- Round Junction Box
- Round Cover for JBOX
- Rectangular JBOX
- Rectangular Cover for RT-BOX
- Wall Mount

Optical Accessories:

- Hexcell Louver

Requires AL (Accessory mount lens):

- Full Glare Shield
- Half Glare Shield
- Visor Shield

Finish:

- Premium quality thermoset polyester powdercoat for a durable finish.

ETL listed, suitable for wet locations.

Rook X Accent

2" Exterior Adjustable Accent



PROJECT:

TYPE:

Ordering Information - Luminaire

1	2	3	4	5	6
1 Model	2 Lens Type	3 Beam Spread	4 Color Temp	5 Finish	6 Optical Accessories
RKX-AS side mount knuckle RKX-AR rear mount knuckle	F flush lens A accessory mount lens	SP spot, 15° NF narrow flood, 22° MFL medium flood, 25° FL flood, 28° WF wide flood, 45° VWF very wide flood, 60° LS6020 linear spread, 60°x20° LS9060 linear spread, 90°x60°	83 CRI 27 2700K-83 30 3000K-83 35 3500K-83 40 4000K-83 90+ CRI 279 2700K-90+ 309 3000K-90+ 359 3500K-90+ 409 4000K-90+	<u>Standard Colors</u> ABZ architectural bronze BLK smooth satin black <u>Premium Colors</u> SDS stardust silver TBK textured black WHT white <i>RAL or custom colors available, consult factory</i>	HEX hexcell louver <u>Requires Accessory mount lens (A):</u> FGS full glare shield HGS half glare shield VS visor shield

Ordering Information - Mounting Accessories (ordered separately)

1	2
1 Model	2 Finish
GSP17 ground stake (<i>black polycarbonate</i>) RDBOX round junction box (<i>specify finish</i>) RDCOV1 round cover for RDBOX, single mounting hole (<i>specify finish</i>) RDCOV2 round cover for RDBOX, dual mounting hole (<i>specify finish</i>) RTBOX rectangular junction box (<i>specify finish</i>) RTCOV1 rectangular cover for RTBOX, single mounting hole (<i>specify finish</i>) RTCOV2 rectangular cover for RTBOX, dual mounting hole (<i>specify finish</i>) WMS14 wall mount (<i>specify finish</i>)	<u>Standard Colors</u> ABZ architectural bronze BLK smooth satin black <u>Premium Colors</u> SDS stardust silver TBK textured black WHT white <i>RAL or custom colors available, consult factory</i>

Rook X Accent

2" Exterior Adjustable Accent



PROJECT:

TYPE:

Ordering Information for Additional or Replacement Optical Films

Luminaire Optics			Secondary Optic Information (Films)	
Optic	Nominal Distribution	Description	Part # for Secondary Optics	Description
SP	17°	Spot	NA	Standard Optic
NF	22°	Narrow Flood	665-0050-1	10° Optical Film
MfL	25°	Medium Flood	665-047-7	15° Optical Film
FL	28°	Flood	665-0051-1	20° Optical Film
WF	45°	Wide Flood	665-0052-1	30° Optical Film
VWF	60°	Very Wide Flood	665-0054-1	60° Optical Film
LS60x20	60°x20°	Asymmetric	665-0062-01	60°x20° Optical Film
LS90x60	90°x60°	Asymmetric	665-0063-04	90°x60° Optical Film
Multiple	Multiple	Kit with all options	301-14781	All above included
All	NA	Film Mounting Ring	607-0386	Mounting Ring for Film

Part #'s above are used to order additional or replacement films. When specifying the original configuration the optic is already included.

Product Details

Side Knuckle Mount (RKX-AS)

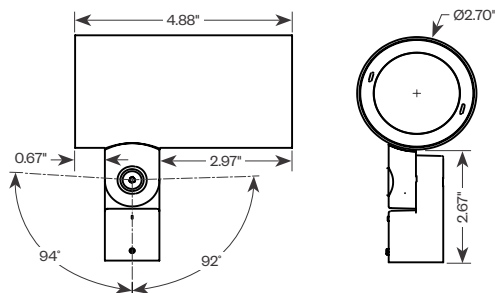

Rear Knuckle Mount (RKX-AR)

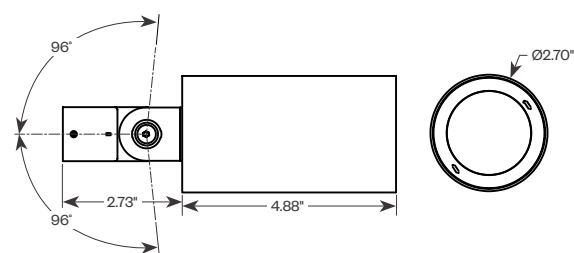

Lens Type



Flush Lens (F)



Accessory Mount Lens (A)

Rook X Accent

2" Exterior Adjustable Accent



PROJECT:

TYPE:

Optical Accessories

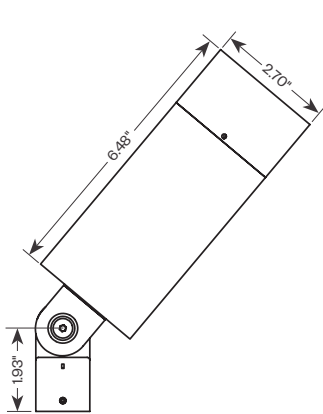

RKX-AR shown with FGS

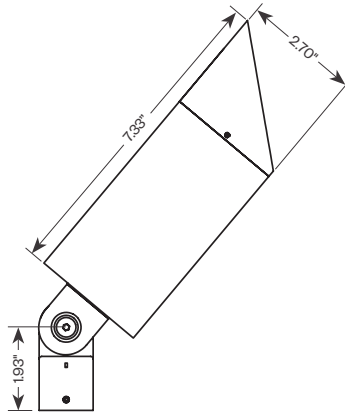

RKX-AR shown with HGS

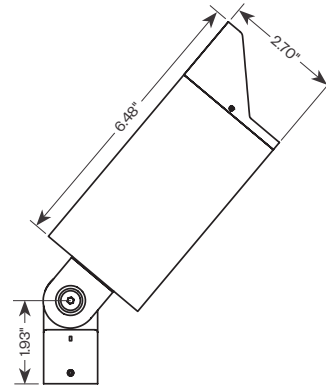

RKX-AR shown with VS

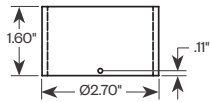

Full Glare Shield (FGS)*

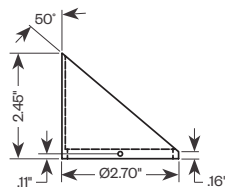

Half Glare Shield (HGS)*

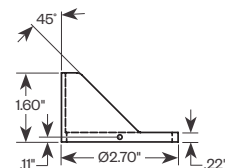

Visor Shield (VS)*

* Requires Accessory mount lens (A) option.



Hexcell Louver (HEX)

(Available for either lens option)

Mounting Accessories (ordered separately)



RDBOX



RDCOV1



RDCOV2



RTBOX



RTCov1



RTCov2

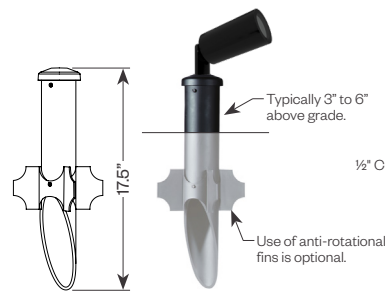

Ground Stake (GSP-17)
(Black Polycarbonate Only)

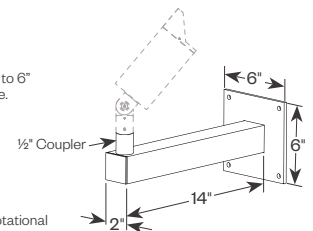

Wall Mount (WMS14)
Mounting hardware
not included
EPA: 0.21



Delta Intelligent Building Technologies

Rook X Accent

2" Exterior Adjustable Accent



PROJECT:

TYPE:

Performance Data

Multiplying Factors: (Multiplying Factor is based on 3000K-83 120V IES file on website)

CCT:	2700K-83	3000K-83	3500K-83	4000K-83	2700K-90+	3000K-90+	3500K-90+	4000K-90+
Factor:	0.96	1.0	1.02	1.04	0.80	0.83	0.87	0.90

Flush Lens

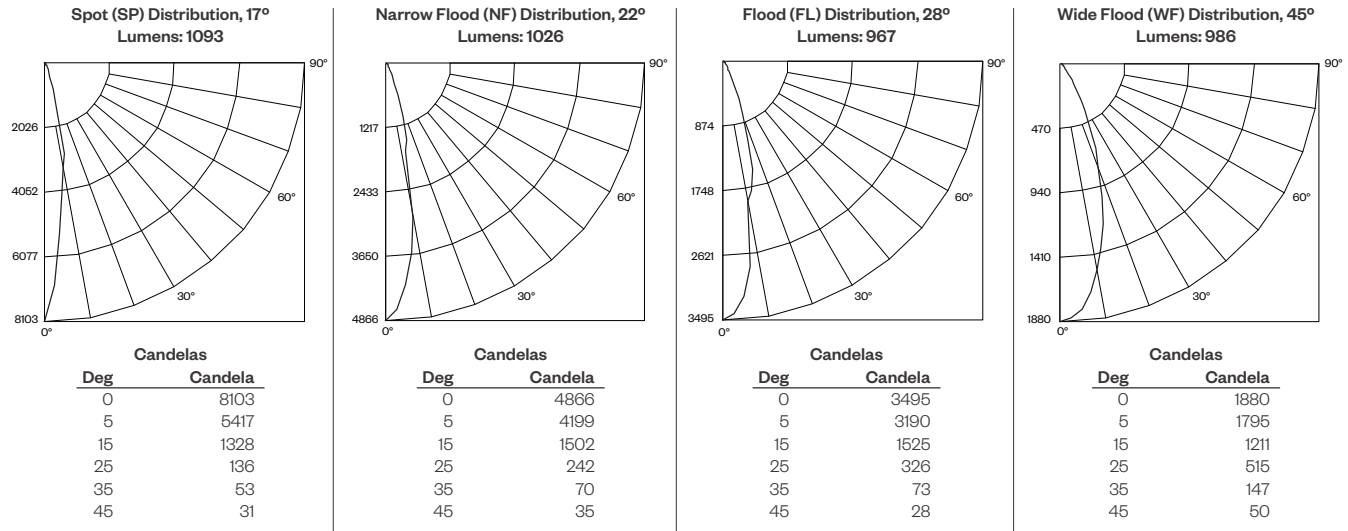

Beam Spread	SP	NF	MFL	FL	WF	VWF	LS9060	LS6020
Description	Spot	Narrow Flood	Medium Flood	Flood	Wide Flood	Very Wide Flood	Asymmetric Linear Spread	Asymmetric Linear Spread
Nominal Degree	15	22	25	28	45	60	90x60	60x20
Lumens	1093	1026	972	967	986	944	907	779

Data shown for 3000K, 80 CRI. For other CCT and CRI options see pg 6.

Performance Data with Optional Shielding

Beam Spread	Accessory	Lumens	Note:
FL	w/o Shielding	962	Performance with shields varies greatly based on beam type. Consult factory for IES files with other beam types.
FL	w/FGS	868	
FL	w/HGS	896	
FL	w/VS	931	

Rook X Accent

2" Exterior Adjustable Accent



PROJECT:

TYPE:

Dimming Compatibility

Amerlux® Rook® fixtures are compatible with all major dimming protocols prevalent in the United States. Please see below for general compatibilities and wiring diagrams. Amerlux recommends testing your unique dimming configuration as the exact full configuration (*Dimmer, Fixture Quantity, Voltage, etc*) may affect dimming performance.

--- NOTE: INFORMATION BELOW IS FOR WIRED DIMMERS ONLY. FOR WIRELESS DIMMERS, CONSULT FACTORY ---

TRIAC (Forward Phase) DIMMING (Standard) or ELV - Electronic Low Voltage (Reverse Phase) DIMMING (Standard)

Notes:

- TRIAC/ELV dimming at 120V only (dimming to 1%)
- Consult Dimming manufacturer for installation instructions - DO NOT SHARE NEUTRALS!
- Must meet dimmer Minimum Load Requirements per dimming manufacturer

TRIAC or ELV Wiring Diagram

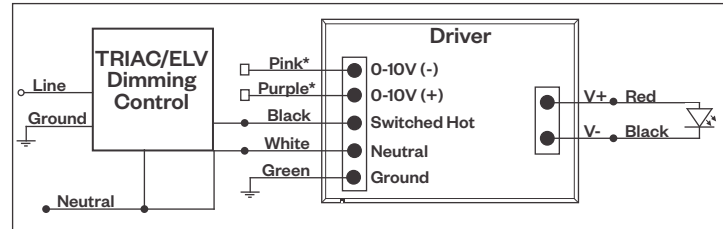

* Pink & Purple wires are not used for TRIAC/ELV dimmer.

0-10V - DIMMING (-0-10V Option)

Integrates into a variety of building management and daylighting controls

Notes:

- 0-10V dimming at 120V or 277V* (dimming to 2%)
- Requires interface to turn off power to driver
- Consult Dimming manufacturer for installation instructions - DO NOT SHARE NEUTRALS!

0-10V Wiring Diagram

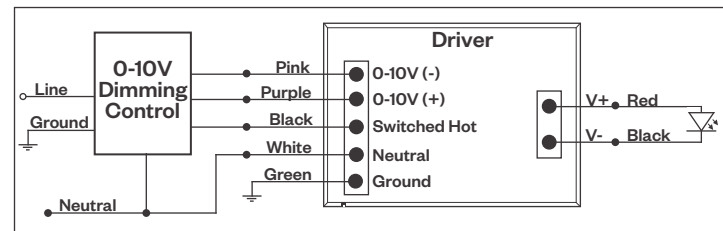

Notes:

* Driver is 277VAC dimmable with appropriate dimmer (*by others*). All provided wiring diagrams show 120VAC wiring colors and method. Please refer to 277VAC dimmer installation instructions for 277VAC wiring diagrams.

† The absence of a dimmer from the lists above does not imply incompatibility. Please consult factory for compatibility inquiries.



Delta Intelligent Building Technologies